

NOTE	VALUE	ISSUE NO.	DATE & NO.	ALTERATIONS	CHK'D
		51	25/6/97	CURRENT ISSUE	

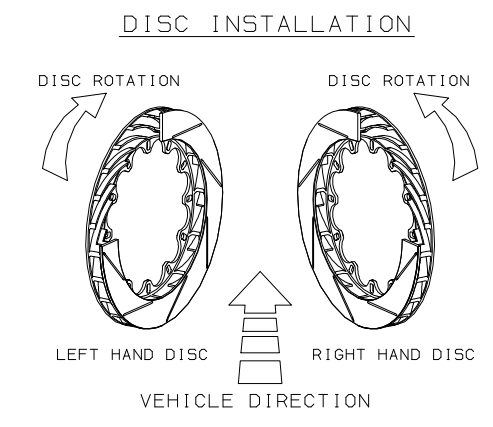
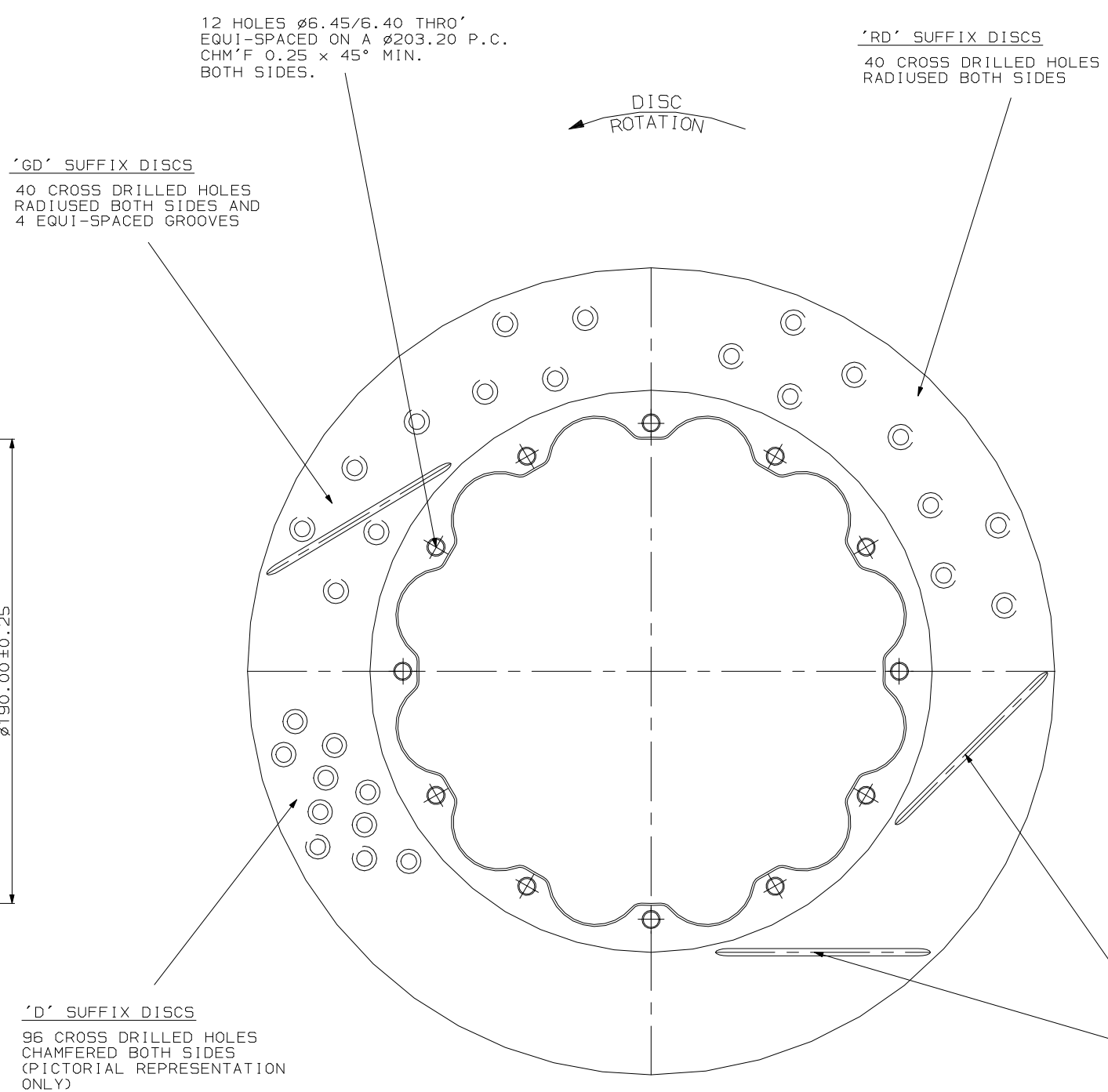
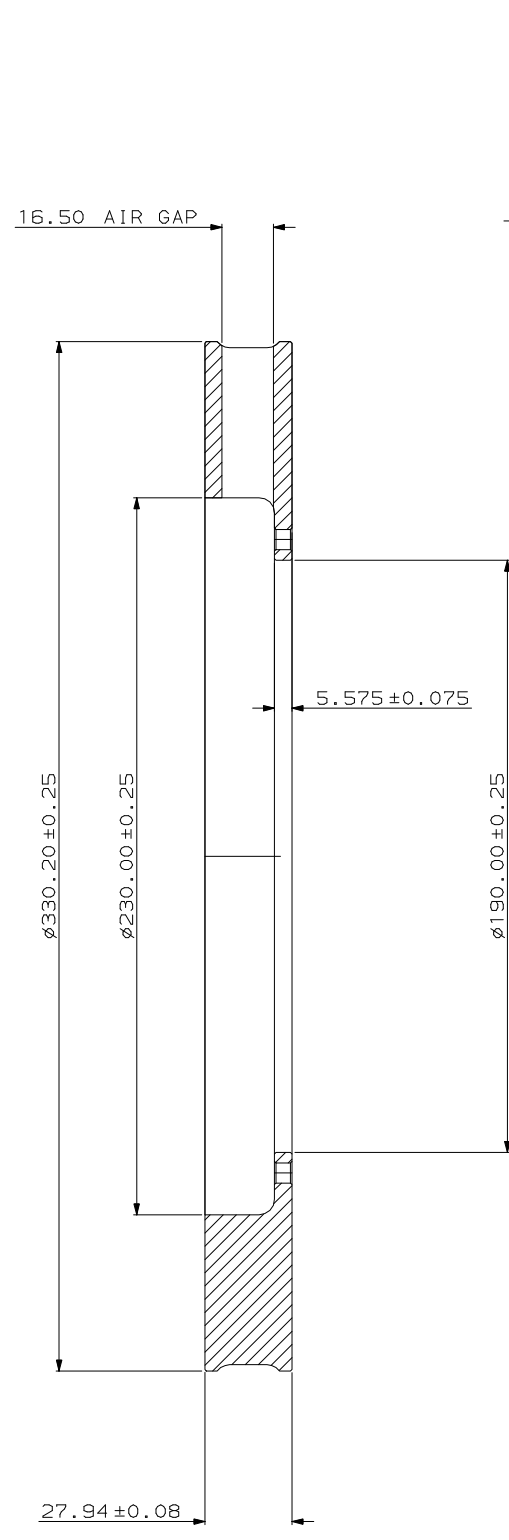

FOR DISC MOUNTING TECHNIQUES, BEDDING PROCEDURE AND DISC COOLING RECOMMENDATION SEE BRAKE CALIPER CATALOGUE.

'G4/G8' SUFFIX DISCS
SPECIFIED NO. OF GROOVES EQUI-SPACED AS SHOWN

R.H AS DRAWN. L.H OPPOSITE.
THIS IS A 48 VANE VENTED DISC OF WEIGHT kg.

SUFFIX TO DISC PART NUMBERS :-
* DENOTES NON STANDARD DISC OPTIONS (LIMITED AVAILABILITY)

SUFFIX	DETAILS
P	PLAIN (NO GROOVES OR HOLES)
D	CROSS DRILLED (HOLES CHAMFERED)
* RD	CROSS DRILLED (REDUCED NO. OF HOLES, HOLES RADIUSED)
* GD	4 GROOVES AND CROSS DRILLED (REDUCED NO. OF HOLES)
GB	GROOVED ONLY (DIGIT SPECIFIES NO. OF GROOVES PER FACE) EG. G4 SPECIFIES 4 GROOVES PER FACE

TEST	UNLESS OTHERWISE STATED:	
	DIMENSIONAL TOLERANCES	± 0.25
	ANGULAR TOLERANCES	$\pm 0.30^\circ$
	MAX SURFACE FINISH:	
	BY ANY METHOD	$\checkmark = \mu\text{m (Ra)}$
	ON MACHINED SURFACES	$\checkmark = \mu\text{m (Ro)}$
	WITHOUT MATERIAL REMOVAL	$\checkmark = \mu\text{m (Ro)}$
	DIMENSIONS IN MILLIMETERS	SHEET SIZE 27"
	DRAWING TO B.S.308.	SIZE 40"
	THREADS TO B.S.3643 PT2 (MEL110).	
	REMOVE BURRS.	
	TITLE	SCALE 1:1
		TRANSLATION SHEET NO(S)
		SHEET NO. TOTAL 1 OF 1

MATERIAL	CAST IRON
MATERIAL SPECIFICATION(S)	
TREATMENT	
DRAWN	STEVE OXLEY
RE-DRAWN	CHECKED
GENERATED FROM	
TITLE	VENTED BRAKE DISC INSTALLATION DRG.
PART NO.	CP3781 -2002 RH -2003 LH
GROUP PART NO.	