

A1 INSTALLATION DRAWING

IF THIS DOCUMENT IS PRINTED IN HARDCOPY, IT IS FOR INFORMATION USE ONLY AND THEREFORE IS NOT SUBJECT TO UPDATING CONTROLS. ALWAYS REFER TO SOLIDWORKS VIEWER FOR LATEST ISSUE



THIS DRAWING IS CONFIDENTIAL AND IS SUPPLIED ON THE EXPRESS CONDITION THAT IT SHALL NOT BE LOANED OR COPIED OR DISCLOSED TO ANY OTHER PERSON OR USED FOR ANY OTHER PURPOSE WITHOUT THE WRITTEN CONSENT OF AP RACING LTD.



AP Racing
Wheler Road
Coventry
CV3 4LB

Tel: +44 (0) 24 7663 9595
Fax: +44 (0) 24 7663 9559
e-mail: engineering@ap racing.co.uk
Web site: <http://www.ap racing.com>

© AP Racing Ltd. 2005

CP6014 - Ø140mm (5.50") SINTERED FOUR PLATE ENDURANCE CLUTCH ASSEMBLY

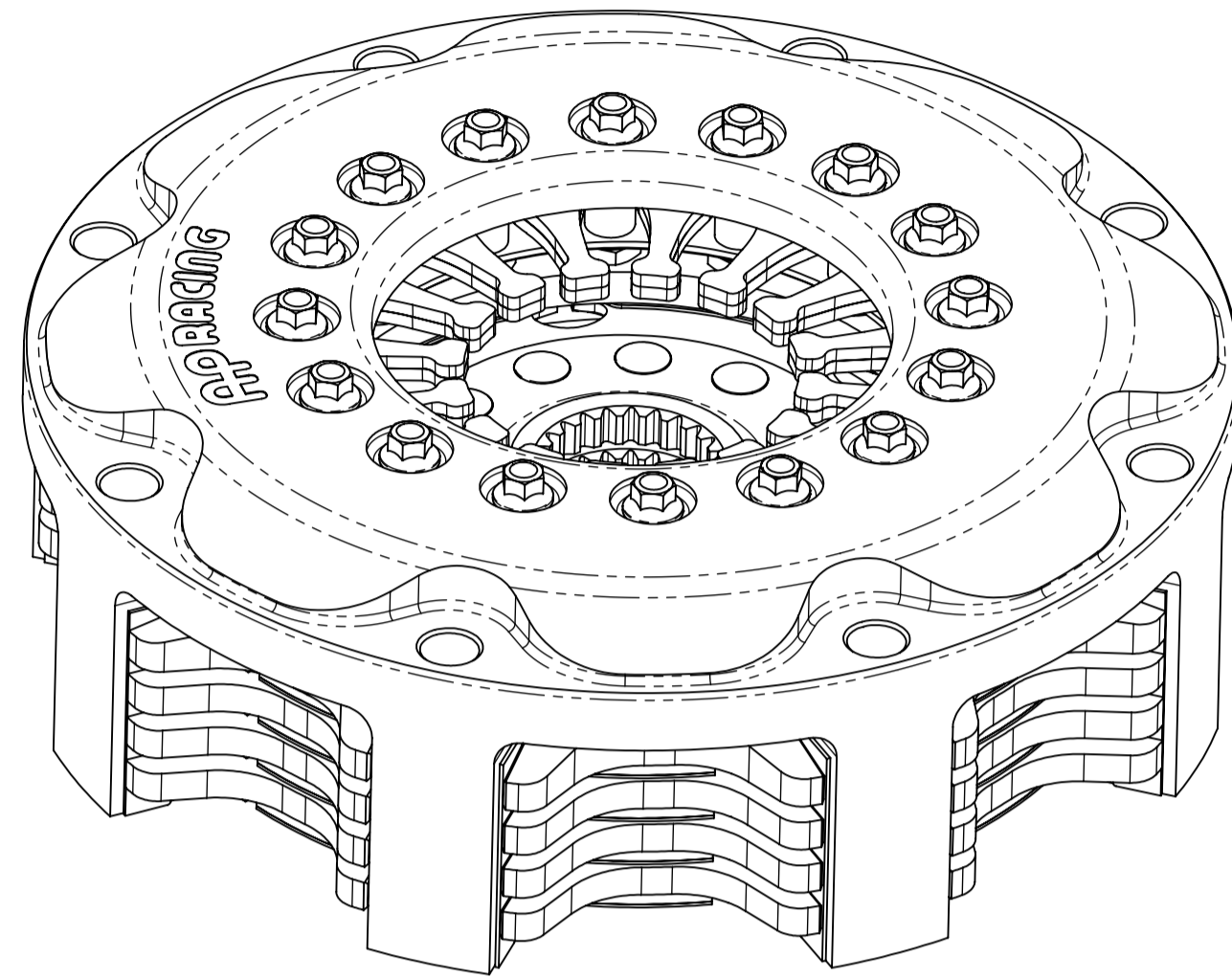

CP6014 CLUTCH FAMILY			
MAXIMUM DYNAMIC TORQUE CAPACITY			
(Nm)	600	804	
(ft.lb)	442	592	
RELEASE LOAD			
Max. Peak Worn (N)	4000	5400	
Max. Peak New (N)	3100	3600	
WEAR IN (See Note)			
	0.75	1.00	
Set Up Height New	43.57	43.83	
	41.75	42.01	
Set Up Height Worn - MAX	45.59	46.52	
(Set Up Height is calculated from the flywheel friction face.)			
Release Ratio	2.65	2.65	
Estimated Assembly Mass (No Driven Plates) = 2.95 Kg			
Estimated Assembly Inertia (No Driven Plates) = 0.011214 Kgm ²			
Estimated Driven Plate Inertia - Sheet 2 for details			

PERFORMANCE SUFFIX	OH	CH			
For Reference					
Diaphragm Spring Rate	ORA	CRV			
Clutch Ratio	HiR	HiR			

MATERIAL SUFFIX	DRIVE PLATE MATERIAL	DRIVE PLATE THICKNESS
90	SINTERED	2.63mm

FLYWHEEL TYPE		
	SUFFIX	COMMENTS
FLAT FLYWHEEL	FF	N/A
STEPPED FLYWHEEL	SF	FOR INSTALLATION DATA SEE SHEET 2

Sample AP Racing Part No.

WEAR IN
THIS CLUTCH HAS BEEN DESIGNED FOR THE WEAR IN INDICATED ABOVE,
DRIVEN PLATE THICKNESS NEW = 2.63mm Nominal
DRIVEN PLATE THICKNESS WORN (1.00 WEAR IN) = 2.38mm Minimum
DRIVEN PLATE THICKNESS WORN (0.75 WEAR IN) = 2.44mm Minimum
FOR DRIVEN PLATE DETAILS SEE SHEET 2

Issue No.	Alterations		Zone	Initials
	Date & No.	Particulars		
11	16/04/13 C4479	REDRAWN INTO THE LATEST FORMAT SHEET. FOR ALL PREVIOUS CHANGES SEE ARCHIVED DRAWING CP6014-1CD. OH90-SF WAS AORA CH90-SF WAS ACRV SUH NOW CALCULATED FROM THE FRICTION FACE CH SPEC 804Nm WAS 840Nm 592ft.lb WAS 620ft.lb 5400N WAS 450daN OH SPEC 600Nm WAS 628Nm 442ft.lb WAS 464ft.lb 4000N WAS 375daN. WEAR-IN 0.75 WAS 1.00	#	JG
12	23/7/19	PICTORIAL UPDATE TO DRIVE PLATES	#	BJP

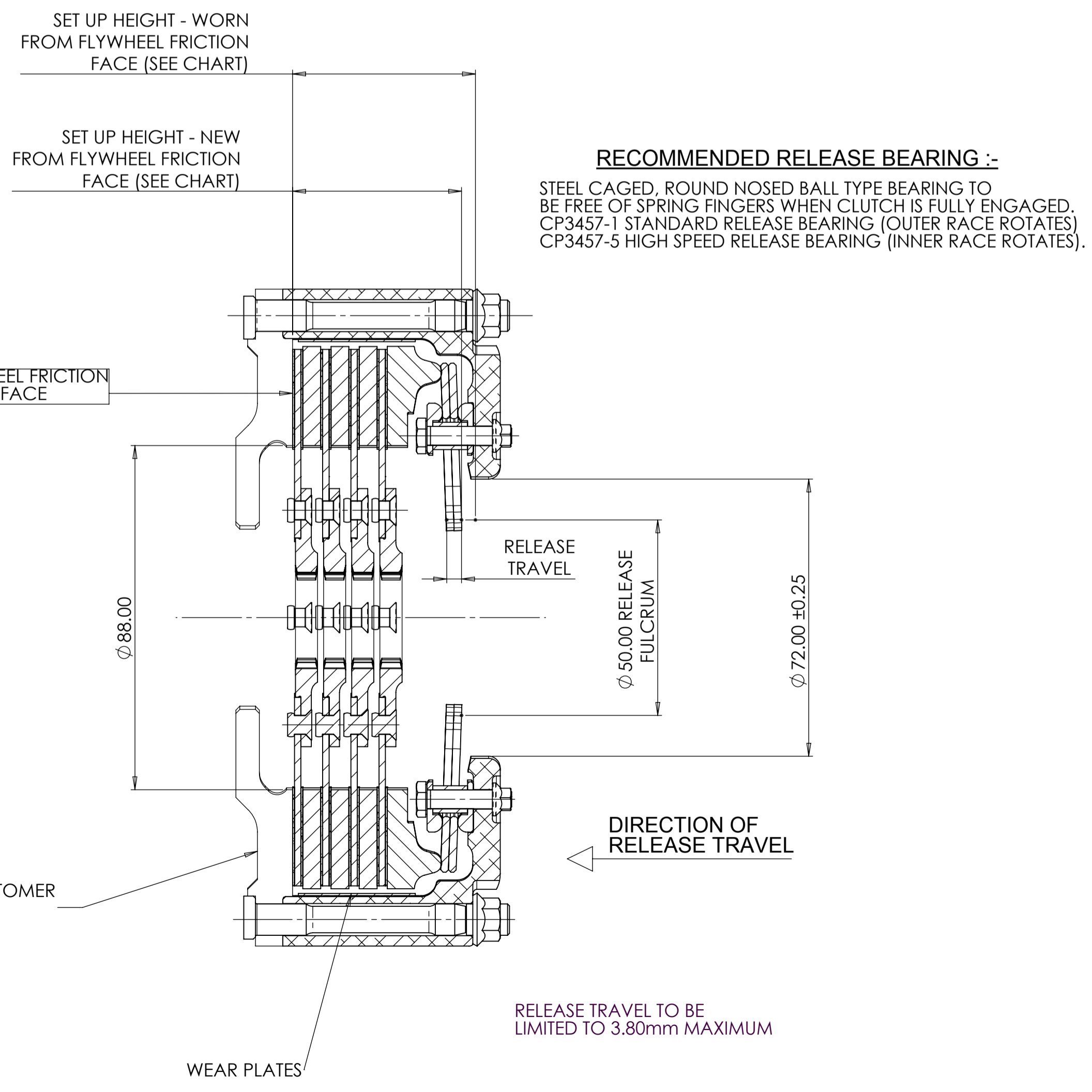

SCALE 1:1	SHEET 1 OF 2
DRAWN	Jeremy Govan
APPROVED	
DERIVED FROM	
TITLE	Ø140mm (5.5") FOUR PLATE SINTERED CLUTCH
DRG NO.	CP6014CD

A1 INSTALLATION DRAWING

IF THIS DOCUMENT IS PRINTED IN HARDCOPY, IT IS FOR INFORMATION USE ONLY AND THEREFORE IS NOT SUBJECT TO UPDATING CONTROLS. ALWAYS REFER TO SOLIDWORKS VIEWER FOR LATEST ISSUE



THIS DRAWING IS CONFIDENTIAL AND IS SUPPLIED ON THE EXPRESS CONDITION THAT IT SHALL NOT BE LOANED OR COPIED OR DISCLOSED TO ANY OTHER PERSON OR USED FOR ANY OTHER PURPOSE WITHOUT THE WRITTEN CONSENT OF AP RACING LTD.



AP Racing
Wheler Road
Coventry
CV3 4LB

Tel: +44 (0) 24 7663 9595
Fax: +44 (0) 24 7663 9559
e-mail: engineering@apracing.co.uk
Web site: <http://www.apracing.com>

© AP Racing Ltd. 2005

Issue No.	Alterations		Zone	Initials
	Date & No.	Particulars		
-	-	SEE SHEET 1 FOR ISSUE INFORMATION.	-	-

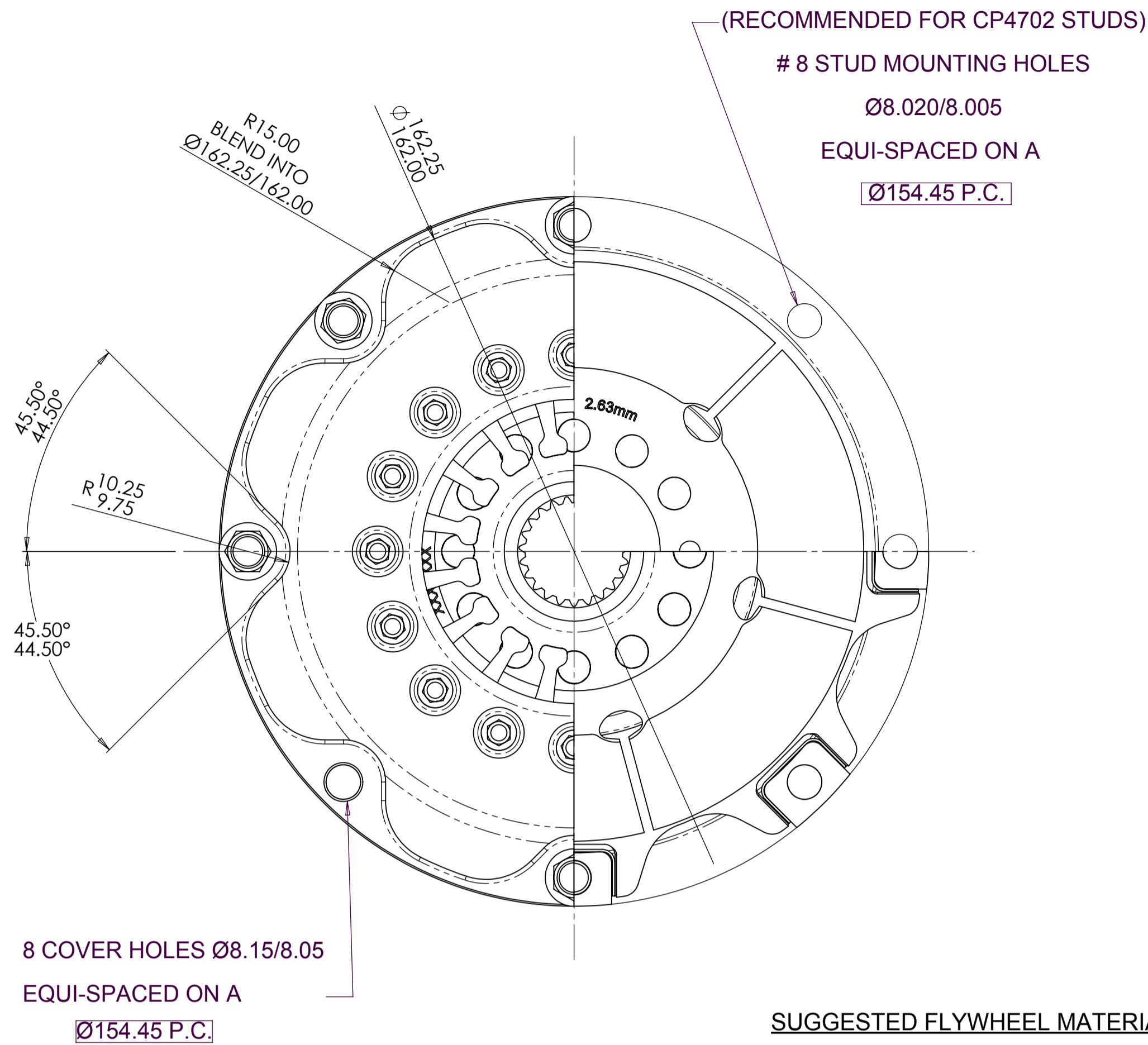

SUGGESTED FLYWHEEL MATERIAL :-
0.35/0.45% CARBON STEEL, BRINELL 200 MIN. OR SUITABLE MATERIAL FOR HIGH RPM. FRICTION FACE TO BE FINE TURNED AND GROUND SMOOTH AND FLAT, RUNOUT AT R77.2 <=0.08 MAX. WHEN ASSEMBLED TO CRANKSHAFT.

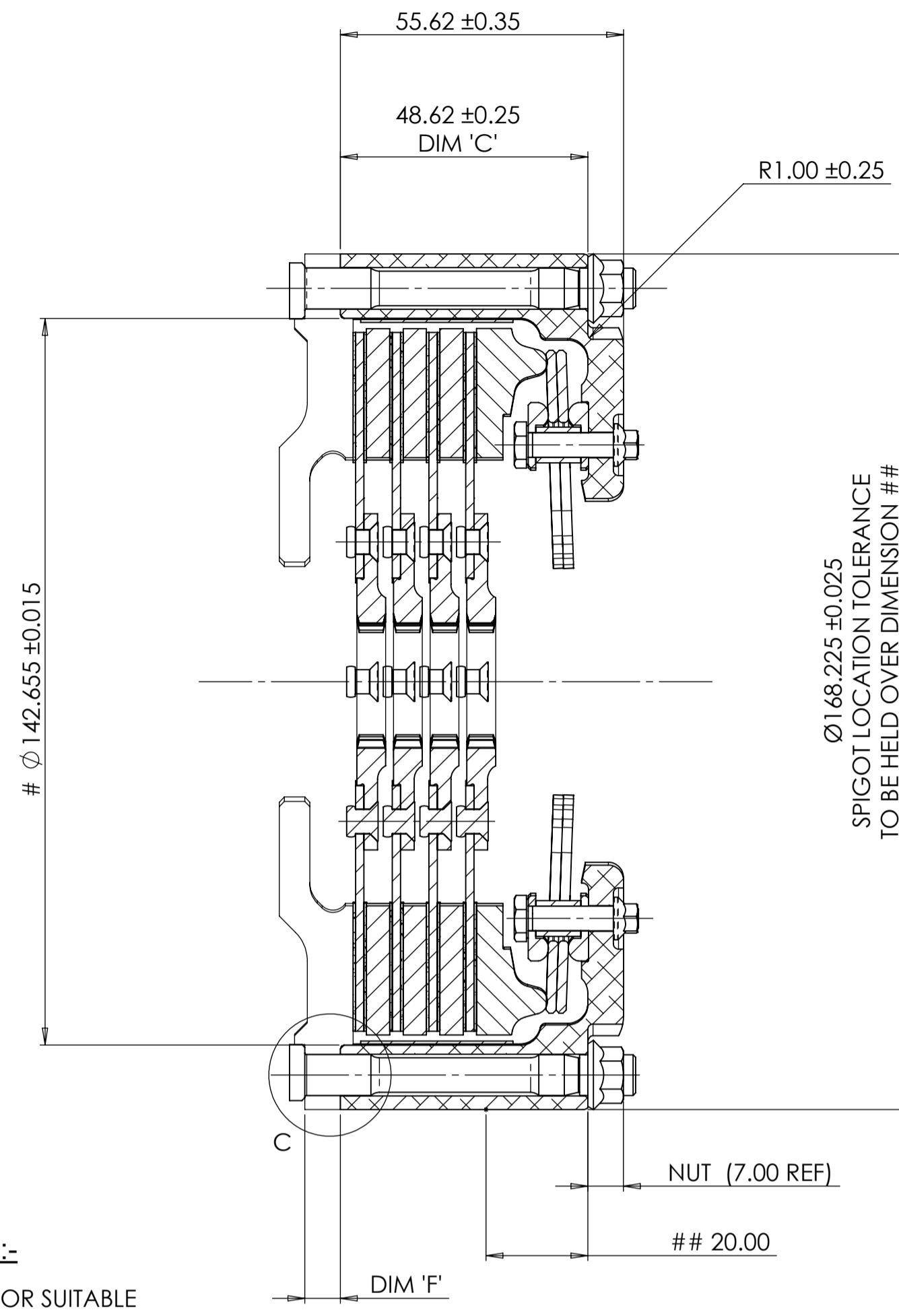

FLYWHEEL DIMENSIONS

RECOMMENDED CLUTCH MOUNTING :
(FOR ALL TYPES OF ASSEMBLY)
M8 x 1.0, CP4702 FAMILY STUD AND K-LOCK NUT.
TIGHTENING TORQUE : 19Nm (14 ft.lb)

LENGTH OF STUD REQUIRED TO BE CALCULATED THUS :

STUD LENGTH = DIMENSIONS 'C' + 'F' + NUT

THIS CALCULATED LENGTH TO BE ROUNDED UP TO THE NEXT AVAILABLE STANDARD STUD LENGTH.

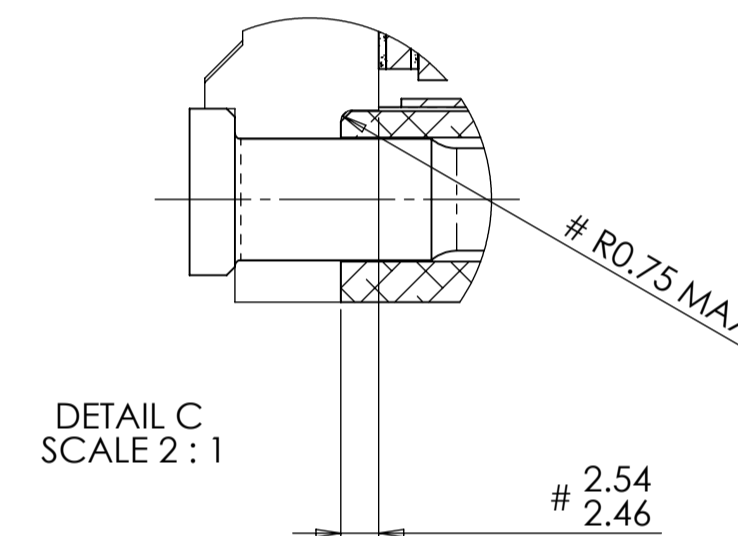

FLYWHEEL DIMENSIONS

DRIVEN PLATE DETAILS

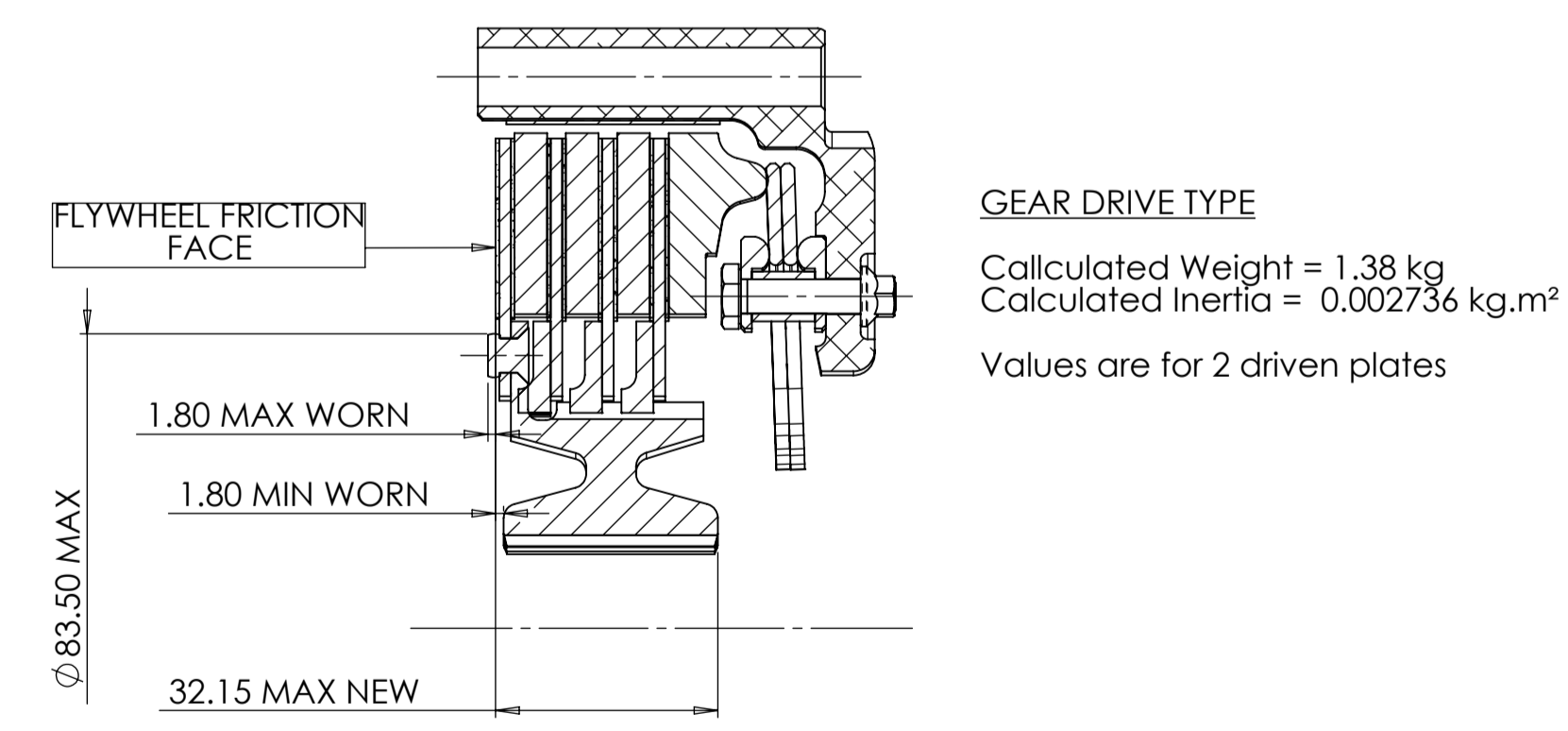
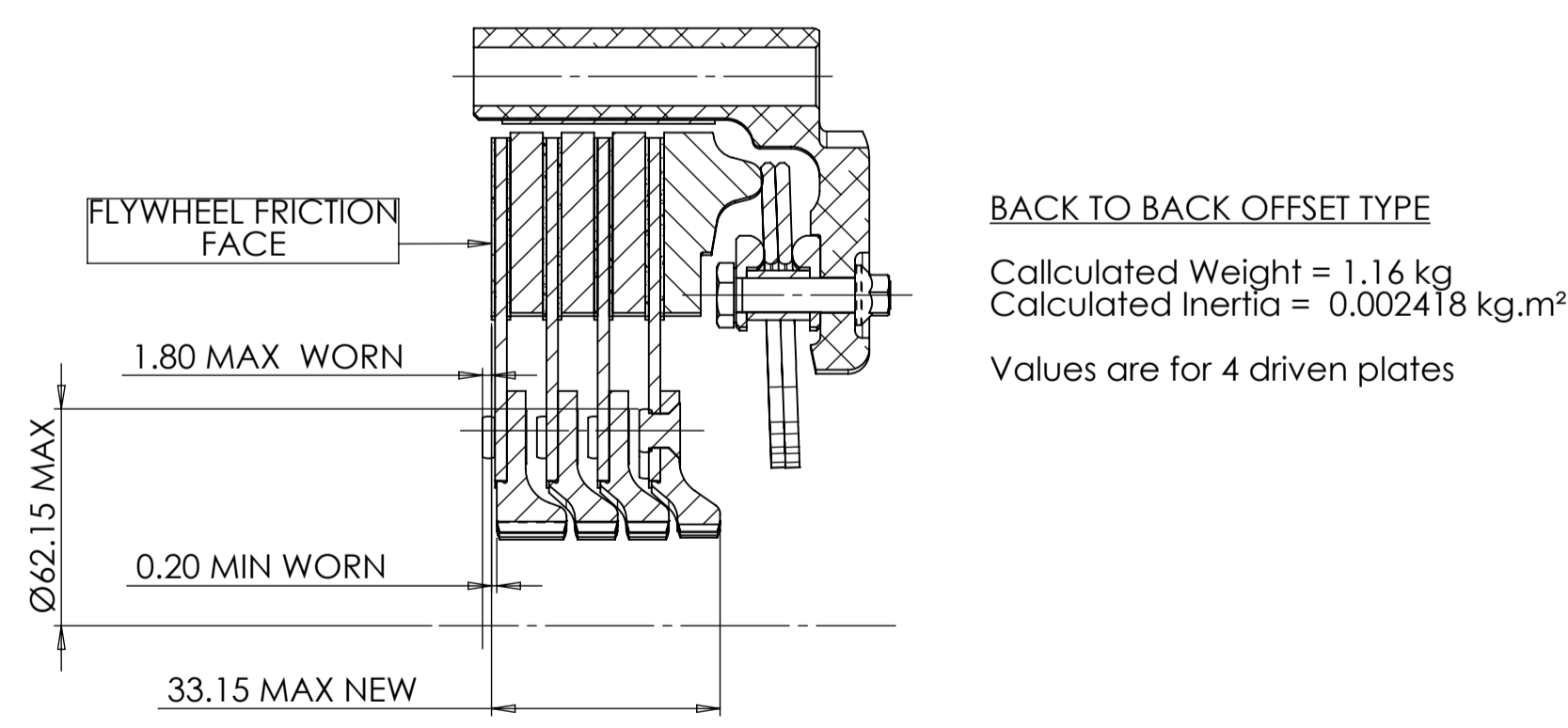
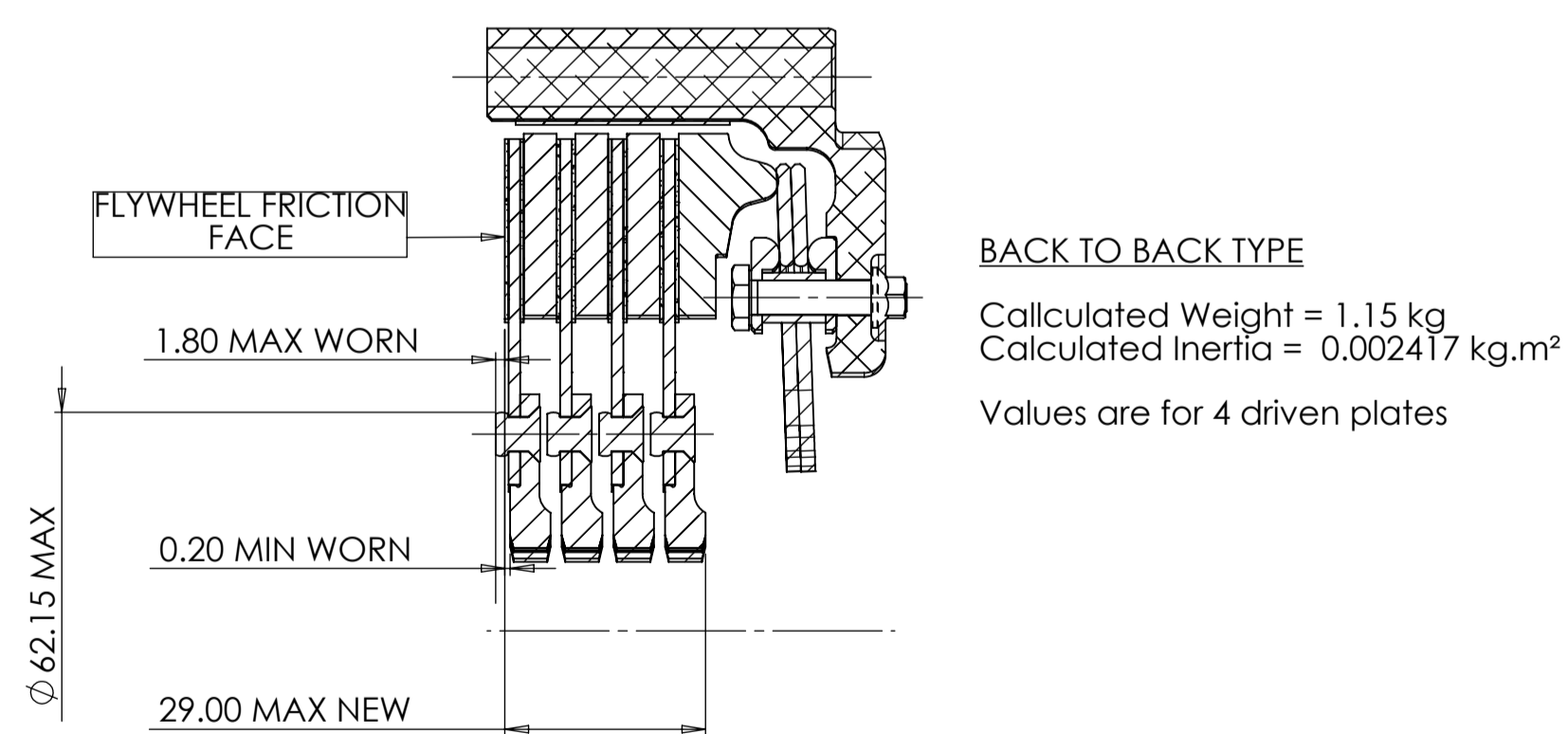

SPLINE	DRIVEN PLATE DETAILS									
	BACK TO BACK TYPE			BACK TO BACK OFFSET TYPE			GEAR DRIVE TYPE			
	PART No.	NUMBER REQUIRED	PART NUMBER	NUMBER REQUIRED	PART No.	NUMBER REQUIRED	PART NUMBER	NUMBER REQUIRED	PART No.	NUMBER REQUIRED
1" x 23T	CP3683-3	4					CP4074-2	1	CP4074-6	3
1" x 24T	CP3683-14	4					CP4074-9	1	CP4074-6	3
7/8" x 20T	CP3683-4	4					CP4074-10	1	CP4074-6	3
1" 5/32" x 26T	CP3683-12	4	CP6014-10	1	CP6014-9	3	CP4074-11	1	CP4074-6	3
29.0 x 10T	CP3686-13	4					CP4074-12	1	CP4074-6	3
1" 1/8" x 10T	CP3683-5	4					CP4074-14	1	CP4074-6	3

SCALE 1:1 SHEET 2 OF 2

DRAWN Jeremy Govan

APPROVED

DERIVED FROM

TITLE

Ø140mm (5.5") FOUR PLATE
SINTERED CLUTCH

DRG NO. CP6014CD