

PART NO.
CP2505-1

IF THIS DOCUMENT IS PRINTED IN HARDCOPY,
IT IS FOR INFORMATION ONLY AND THEREFORE
NOT SUBJECT TO UPDATING CONTROLS. ALWAYS
REFER TO VIEWSTATION FOR THE LATEST ISSUE.

FIRST ANGLE
PROJECTION

DO NOT
SCALE

THIS DRAWING IS CONFIDENTIAL AND IS SUPPLIED ON THE EXPRESS CONDITION THAT
IT SHALL NOT BE LOANED OR COPIED OR DISCLOSED TO ANY OTHER PERSON OR USED
FOR ANY PURPOSE WITHOUT THE WRITTEN CONSENT OF AUTOMOTIVE PRODUCTS p.l.c

YEAR
19 97

AUTOMOTIVE PRODUCTS p.l.c
RACING

NOTE

VALUE

ISSUE NO.	ALTERATIONS	
	DATE & NO.	PARTICULARS
3	02/04/97 B1705	REDRAWN ON CAD

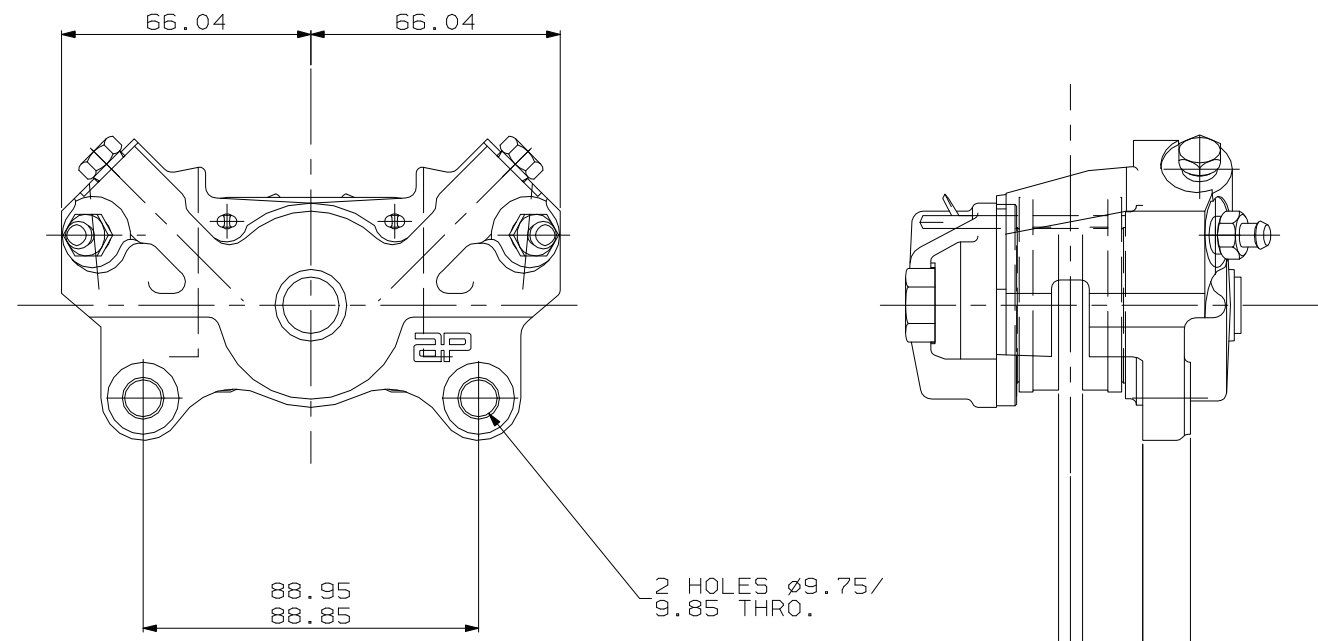

2 HOLES ϕ 9.75/
9.85 THRO.

7.11
DISC WIDTH

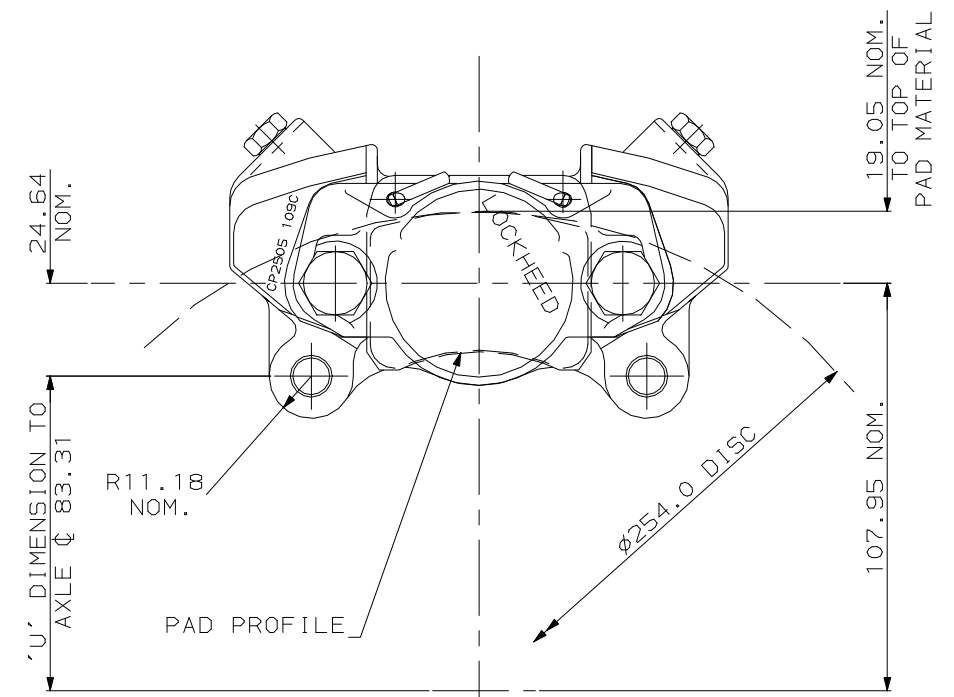

24.54
NOM.

'U' DIMENSION TO
AXLE ϕ 83.31

R11.18
NOM.

PAD PROFILE

NOTE

VALUE

ISSUE NO.	ALTERATIONS	
	DATE & NO.	PARTICULARS
3	02/04/97 B1705	REDRAWN ON CAD

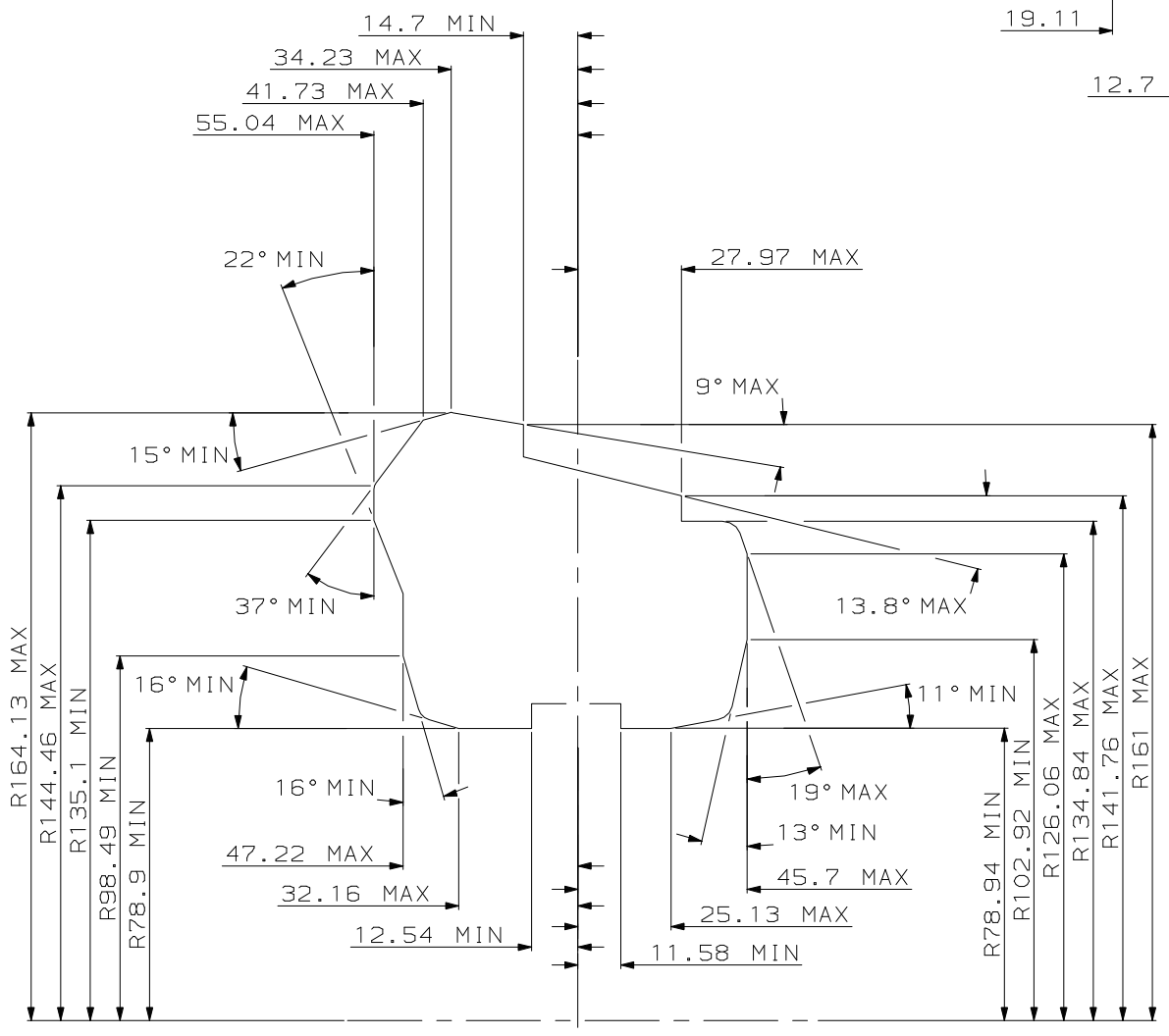

RADIAL PROFILE ON A ϕ 254.0mm DISC.

GENERAL DESCRIPTION

THIS IS A TWO PISTON CALIPER DESIGNED
TO OPERATE ON A SOLID DISC OF ϕ 254.0,
WITH A DISC WIDTH OF 7.11 . IT HAS
INTERNAL HOLES TO PROVIDE FLUID TO
THE COVER HALF. NON-HANDED CALIPER.

TYPICAL APPLICATIONS

FORMULA FORD

TECHNICAL & INSTALLATION INFORMATION

PISTON AREA - 26.68cm²
PISTON MATERIAL - STEEL
BODY MATERIAL - CAST IRON
HYDRAULIC THREADS - 3/8" x 24 UNF.
CALIPER WEIGHT LESS PADS - 2000 grams

TEST		SHEET SIZE	SCALE	TRANSLATION SHEET No(S)
UNLESS OTHERWISE STATED: DIMENSIONAL TOLERANCES ANGULAR TOLERANCES MAX SURFACE FINISH: BY ANY METHOD ON MACHINED SURFACES WITHOUT MATERIAL REMOVAL				
DIMENSIONS IN MILLIMETERS. DRAWING TO B.S. 308. THREADS TO B.S. 3643 PT2 (MEL110). REMOVE BURRS.				
TITLE		SHEET NO. TOTAL 1 of 1		

MATERIAL

MATERIAL SPECIFICATION(S)

TREATMENT

DRAWN	CDA 02/04/97	CHECKED	#
RE-DRAWN		CHECKED	#

GENERATED FROM

TITLE
1.625" CALIPER
CALIPER INSTALLATION

PART NO.
CP2505-1

GROUP PART NO.