

# A1 INSTALLATION DRAWING

IF THIS DOCUMENT IS PRINTED IN HARDCOPY, IT IS FOR INFORMATION USE ONLY AND THEREFORE IS NOT SUBJECT TO UPDATING CONTROLS. ALWAYS REFER TO SOLIDWORKS VIEWER FOR LATEST ISSUE



THIS DRAWING IS CONFIDENTIAL AND IS SUPPLIED ON THE EXPRESS CONDITION THAT IT SHALL NOT BE LOANED OR COPIED OR DISCLOSED TO ANY OTHER PERSON OR USED FOR ANY OTHER PURPOSE WITHOUT THE WRITTEN CONSENT OF AP RACING LTD.



AP Racing  
Wheler Road  
Coventry  
CV3 4LB

Tel: +44 (0) 24 7663 9595  
Fax: +44 (0) 24 7663 9559  
e-mail: [engineering@apracings.com](mailto:engineering@apracings.com)  
Web site: <http://www.apracings.com>

© AP Racing Ltd. 2005

**DISC PART NUMBERS:**

CP4136-924 NON HANDED

THIS IS A 36 VANES DISC OF MASS 3.25Kg

THIS DISC WAS DESIGNED TO WORK WITH A D46 DEPTH PAD.

FOR DISC MOUNTING TECHNIQUES, BEDDING PROCEDURE AND DISC COOLING RECOMMENDATIONS SEE AP RACING BRAKE DISC CATALOGUE.

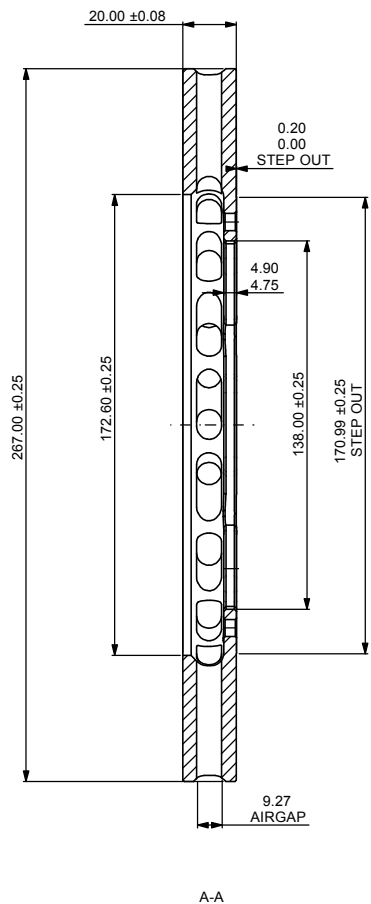

8 HOLES Ø6.45/6.40 THRO'  
EQUISPACED ON A Ø152.00 PCD

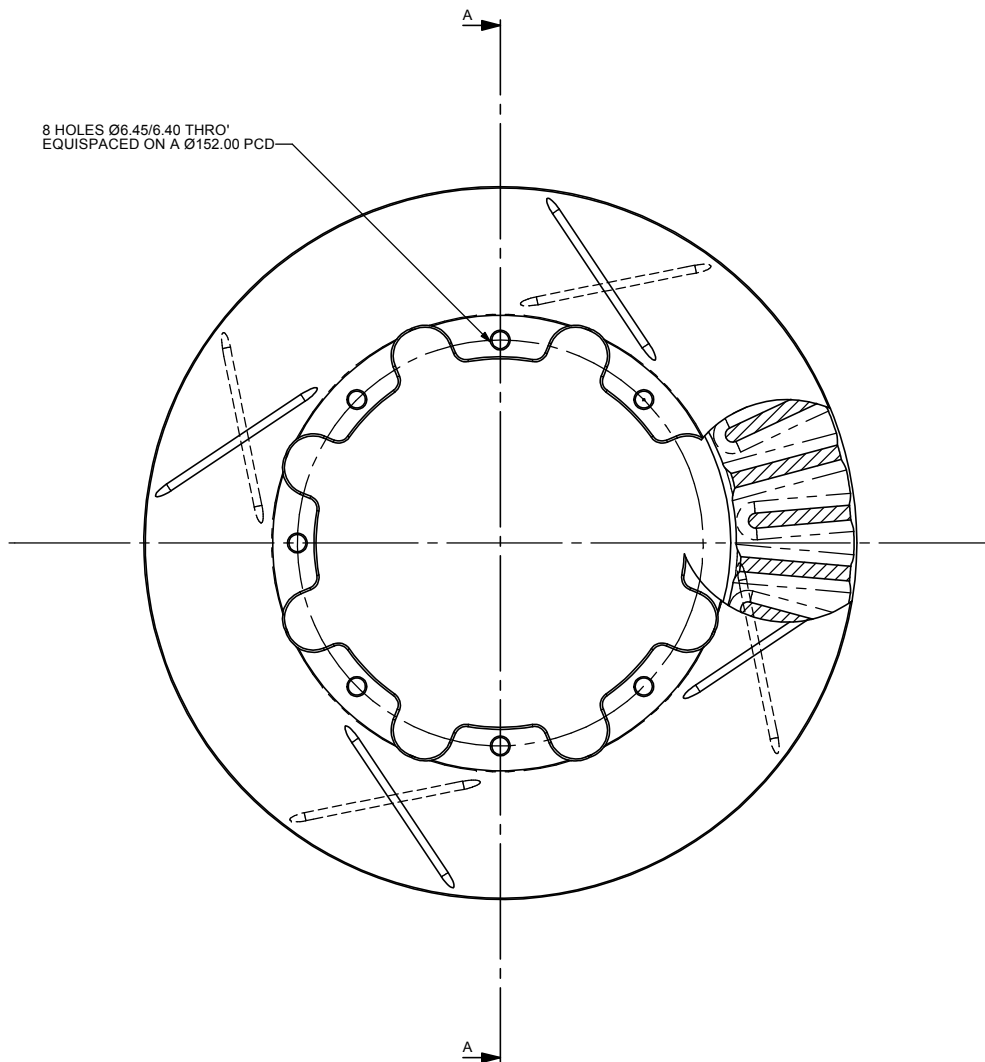

Issue No.	Alterations		Zone	Initials
	Date & No.	Particulars		
1	26/01/07 B4744	FIRST ISSUE		CDA

SCALE 1:1		SHEET 1 OF 1	
DRAWN	Chris Arrowsmith		
APPROVED			
DERIVED FROM			
TITLE			
Ø267.00 x 20.00			
VENTILATED DISC			
DRG NO.	CP4136-924G4		