

A1 INSTALLATION DRAWING

IF THIS DOCUMENT IS PRINTED IN HARD COPY, IT IS FOR INFORMATION USE ONLY AND THEREFORE IS NOT SUBJECT TO UPDATING CONTROLS. ALWAYS REFER TO SOLIDWORKS VIEWER FOR LATEST ISSUE



THIS DRAWING IS CONFIDENTIAL AND IS SUPPLIED ON THE EXPRESS CONDITION THAT IT SHALL NOT BE LOANED OR COPIED OR DISCLOSED TO ANY OTHER PERSON OR USED FOR ANY OTHER PURPOSE WITHOUT THE WRITTEN CONSENT OF AP RACING LTD.

AP RACING
 © AP Racing Ltd. 2001
 AP Racing
 Wheler Road
 Coventry
 CV3 4LB
 Tel: +44 024 7663 9595 e-mail: sales@apracing.co.uk
 Fax: +44 024 7663 9559 Web site: HTTP://www.apracing.com

IT IS ADVISABLE TO WIRE PAD CLIPS IN POSITION.

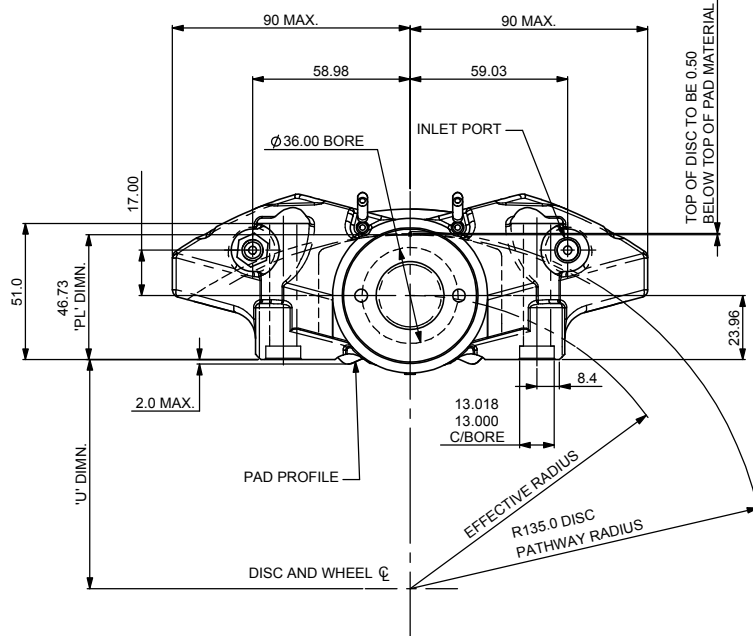
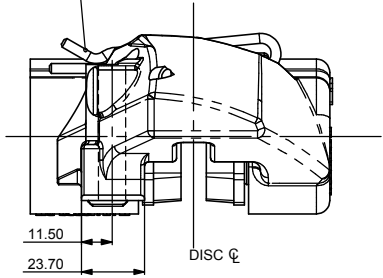

GENERAL DESCRIPTION:
 THIS CALIPER IS DESIGNED TO OPERATE ON CAST IRON DISCS DIAMETER Ø265 mm AND THICKNESS 9.7 mm. SEALS ARE HIGH TEMPERATURE 'SEAL-IN-BORE' TYPE.

TYPICAL APPLICATION:
 RALLY REAR BRAKES

TECHNICAL INFORMATION:
 TOTAL PISTON AREA: 20.4 cm²
 PISTON MATERIAL: ALUMINIUM ALLOY
 BODY MATERIAL: ALUMINIUM ALLOY
 HYDRAULIC CONNECTIONS: 3/8" x 24 UNF
 BRAKE PADS: CP2399 FAMILY
 ASSEMBLY WEIGHT: 1.1 Kg. (WITHOUT PADS)

INSTALLATION INFORMATION:
 DISC & CALIPER MOUNTING TOLERANCES TO BE SUCH THAT THE DISC IS CENTRAL TO THE CALIPER TO WITHIN ±0.5 mm.
 CALIPER IS HANDED BY SWITCHING POSITIONS OF BLEED SCREW AND INLET PORT.
 CALIPER TO BE MOUNTED ON ITS SIDE, WITH BLEED SCREW UPPERMOST.

KEY TO DIMENSIONS:
 DIMENSION 'PL': TOP OF PAD MATERIAL TO MOUNTING BOSS FACE WITH PAD SITTING DOWN ON RETAINING CLIPS.
 DIMENSION 'U': WHEEL CENTRE LINE TO CALIPER MOUNTING BOSS FACE = (DISC Ø/2) - DIMENSION 'PL'.
 DIMENSION 'C': OFFSET, DISC CENTRE LINE TO MOUNTING HOLES.
 EFFECTIVE RAD: DISTANCE FROM WHEEL CENTRE LINE TO NOMINAL PISTON CENTRE LINE.

AP RACING TECHNICAL SECTION WILL BE PLEASED TO ADVISE ON THE MOST SUITABLE EQUIPMENT FOR ANY PARTICULAR APPLICATION.

REPLACEMENT SEAL KIT
 SEAL KIT (HIGH TEMPERATURE) CP4518-H

Issue No.	Alterations		Zone	Initials
	Date & No.	Particulars		
1	11/12/03 B3823	FIRST ISSUE		SAT

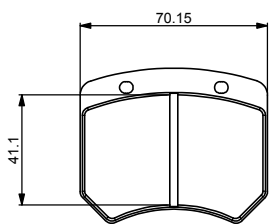
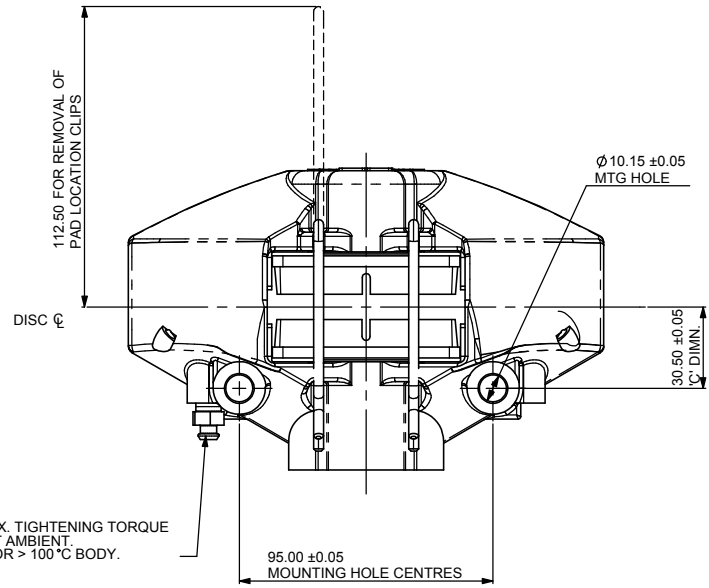
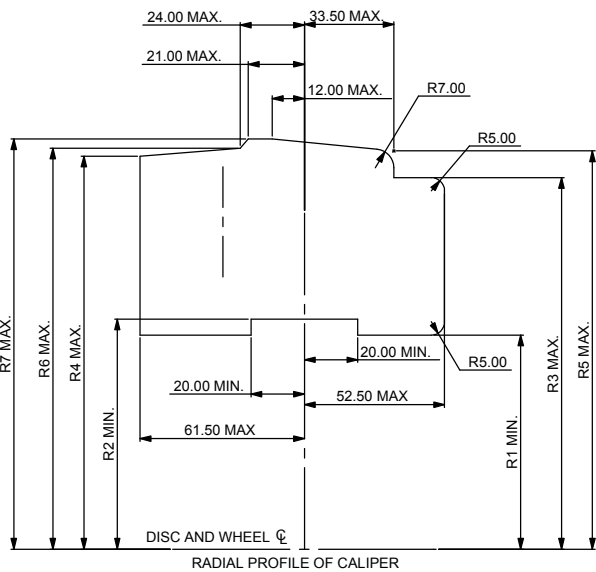

CP2399 PAD FAMILY
 PAD AREA - SLOTTED :- 27.66 cm²
 - FULL AREA :- 28.95 cm²
 PAD THICKNESS :- 14.35 mm

BLEED SCREW MAX. TIGHTENING TORQUE
 25Nm (18.5 LbFt) AT AMBIENT.
 17Nm (12.5 LbFt) FOR > 100 °C BODY.

DISC Ø	DISC WIDTH	R1	R2	R3	R4	R5	R6	R7	EFF RAD	U' DIMIN
265.0	9.7	80.2	86.2	139.2	147.2	149.2	150.2	153.7	109.7	85.77

SCALE 1:1 SHEET 1 OF 1
 DRAWN Steve Thomas
 APPROVED
 DERIVED FROM
 TITLE
 P.V.2/26 CALIPER
 INSTALLATION DRAWING
 DRG NO. cp4586-6cd