

A0 INSTALLATION DRAWING

IF THIS DOCUMENT IS PRINTED IN HARD COPY, IT IS FOR INFORMATION USE ONLY AND THEREFORE IS NOT SUBJECT TO UPDATING CONTROLS. ALWAYS REFER TO SOLIDWORKS VIEWER FOR LATEST ISSUE

FIRST ANGLE PROJECTION

THIS DRAWING IS CONFIDENTIAL AND IS SUPPLIED ON THE EXPRESS CONDITION THAT IT SHALL NOT BE LOANED OR COPIED OR DISCLOSED TO ANY OTHER PERSON OR USED FOR ANY OTHER PURPOSE WITHOUT THE WRITTEN CONSENT OF AP RACING LTD.

AP RACING
 © AP Racing Ltd. 2003
 AP Racing
 Wheler Road
 Coventry
 CV3 4LB

Tel: +44 024 7663 9595 e-mail: sales@apracinc.co.uk
 Fax: +44 024 7663 9599 Web site: HTTP://www.apracinc.com

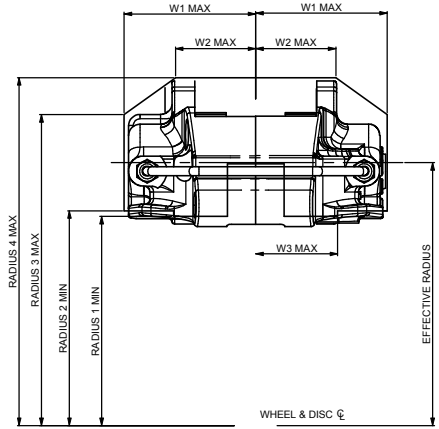
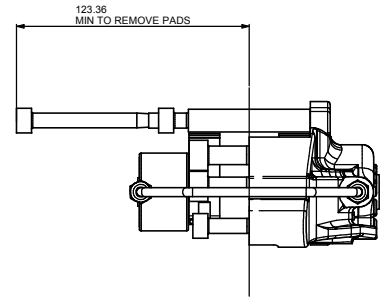

RADIAL PROFILE CHART

	DISC Ø	EFF RAD	RAD 1	RAD 2	RAD 3	RAD 4	W1	W2	W3
CP5040-2/3/4/5	330.20	139.30	110.80	113.80	164.80	184.40	69.70	42.50	43.45
	315.00	132.10	103.30	106.30	157.50	178.60			

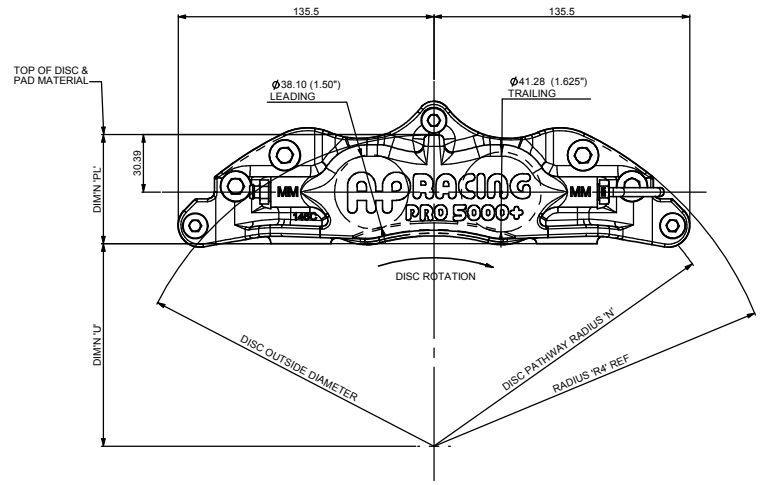

GENERAL DESCRIPTION
 THIS CALIPER IS DESIGNED TO OPERATE ON A SOLID OR VENTILATED DISC OF EITHER Ø330.2 (13.0") OR Ø315.0 (12.4")
 ALL CALIPERS ARE FITTED WITH STAINLESS STEEL FLUID BRIDGE PIPES.
 PISTON DIAMETERS: 2 x 41.28 (1.625") TRAILING
 2 x 38.10 (1.500") LEADING
 BODY MATERIAL: ALUMINIUM ALLOY
 HYDRAULIC THREADS: M10 x 1.0
 PISTON MATERIAL: ALUMINIUM ALLOY (STANDARD)
 DIMENSION 'PL': TOP OF PAD MATERIAL TO MOUNTING HOLE BOSS FACE WITH PAD SITTING DOWN ON LEDGE.
 DIMENSION 'C': OFFSET - DISC CENTRE LINE TO MOUNTING HOLE CTR
 DIMENSION 'D': MOUNTING HOLE CENTRES
 DIMENSION 'H': MOUNTING HOLE DIAMETER
 DIMENSION 'U': WHEEL CENTRE TO CALIPER MOUNTING HOLE BOSS FACE (DISC Ø/2) - 'PL' DIMENSION
 AP RACING TECHNICAL SECTION WILL BE PLEASED TO ADVISE ON THE MOST SUITABLE EQUIPMENT FOR ANY PARTICULAR APPLICATION.
 CALIPER PART NUMBERS
 CP5040-2S4 - R-H TRAILING (BEHIND AXLE)
 CP5040-3S4 - L-H TRAILING (BEHIND AXLE)
 CP5040-4S4 - R-H LEADING (IN FRONT OF AXLE)
 CP5040-5S4 - L-H LEADING (IN FRONT OF AXLE)
 THE ADDITION OF AN 'L' SUFFIX DENOTES STAINLESS STEEL PISTONS RATHER THAN THE STANDARD ALUMINIUM ALLOY PISTONS

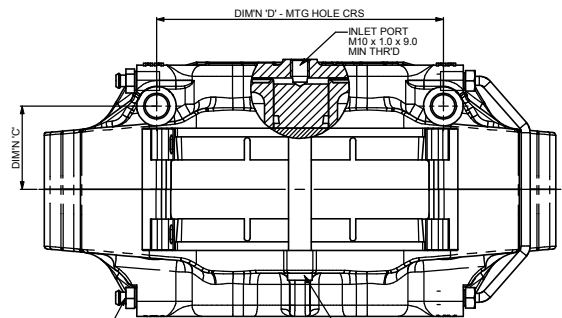

BLEED SCREW TIGHTENING TORQUE: 17.0 Nm (12.5 Lbs ft)
 PAD RETAINING BOLTS SHOULD BE TIGHTENED TO A TORQUE OF 13.1Nm (9.7 Lbs ft)

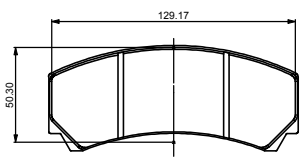

CP3215 PAD FAMILY
 PAD AREA - 57.37cm²
 PAD VOLUME - 97.53cm³

Rev	Date & No.	Alterations		Zone	Status
		Particulars			
1	13/05/03 B3649		FIRST ISSUE		SAT
2	15/02/07 B4750		PART No. 'L' SUFFIX NOTE ADDED		SAT

SCALE 1:1	SHEET 1 OF 1
DRAWN Steve Thomas	
APPROVED	
DERIVED FROM	
TITLE 4 POT, 2 PIECE CALIPER INSTALLATION	
DRG NO. cp5040-1cd	