

A0 INSTALLATION DRAWING

IF THIS DOCUMENT IS PRINTED IN HARD COPY, IT IS FOR INFORMATION USE ONLY AND THEREFORE IS NOT SUBJECT TO UPDATING CONTROLS. ALWAYS REFER TO SOLIDWORKS VIEWER FOR LATEST ISSUE

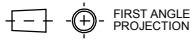

THIS DRAWING IS CONFIDENTIAL AND IS SUPPLIED ON THE EXPRESS CONDITION THAT IT SHALL NOT BE LOANED OR COPIED OR DISCLOSED TO ANY OTHER PERSON OR USED FOR ANY OTHER PURPOSE WITHOUT THE WRITTEN CONSENT OF AP RACING LTD.

AP Racing Ltd. 2005
 AP Racing
 Wheler Road
 Coventry
 CV3 4LB
 Tel: +44 024 7663 9595
 Fax: +44 024 7663 9559
 e-mail: sales@apracings.co.uk
 Web site: HTTP://www.apracings.com

| Alterations | | |
|--------------|-------------|-------|
| Date & No. | Particulars | Zone |
| 1 28/07/2010 | FIRST ISSUE | # COA |

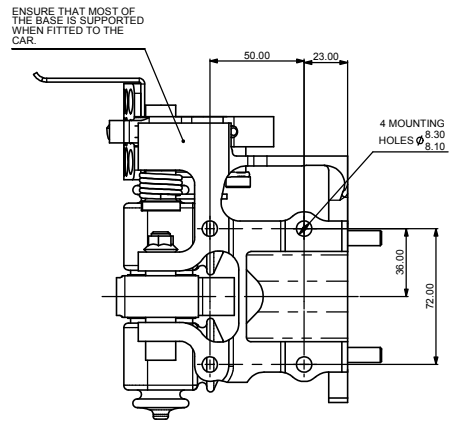

FOR OPTIONAL EXTRAS & SPARES SEE SHEET 2

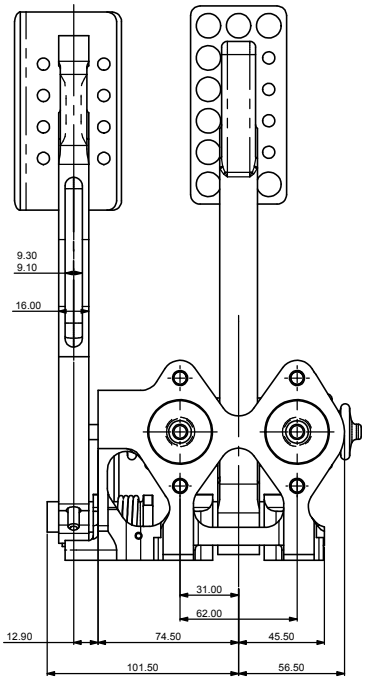

GENERAL DESCRIPTION

THIS PEDAL BOX IS A GENERIC RACING PEDAL BOX DESIGN. DESIGNED FOR COMFORT AND CONTROL. THIS UPDATED PEDAL BOX HAS A NEW OPTIMISED MACHINED FROM BILLET BASE PLATE AND PEDALS. THE THROTTLE HAS BEEN UPDATED TO ADD ADDITIONAL FEATURES TO AID CONNECTION TO BELL CRANKS AND CABLES.

FEATURES

- OPTIMISED, LIGHTWEIGHT, MACHINED FROM BILLET.
- OPTIMISED, LIGHTWEIGHT BRAKE PEDAL, WITH IMPROVED TWIST DISPLACEMENT.
- NEW FORGED THROTTLE PEDAL WITH ADDITIONAL FEATURES.
- ADJUSTABLE RATIO PEDALS.
- ALL THREADS ARE METRIC, EXCEPT THOSE MENTIONED BELOW.
- Ø10 BALANCE BAR
- ADJUSTABLE STOP ON THROTTLE PEDAL.
- PEDAL BOX WEIGHT IS TBA Kg (CP2623 MASTER CYLINDERS APPROX 0.31Kg EACH)
- CABLE ADJUSTER INCLUDED.
- ALL PEDALS HAVE BALL BEARING PIVOTS.

PART NUMBER

CP5500-525MET - METRIC, PEDAL BOX WITH BRAKE AND THROTTLE

CP5500-525UNF - IMPERIAL, PEDAL BOX WITH BRAKE AND THROTTLE THE ONLY THREADS THAT ARE IMPERIAL ARE THE 3 CLEVIS'S THAT ATTACH TO THE MASTER CYLINDER PUSHRODS.

| BORE SIZE | BRAKE PEDAL |
|-------------------------|------------------|
| Ø14.0mm (0.551") | CP2623-88PRM088 |
| Ø15.0mm (0.591") | CP2623-89PRM088 |
| Ø15.9mm (0.625") 5/8" | CP2623-90PRM088 |
| Ø16.8mm (0.661") | CP2623-905PRM088 |
| Ø17.8mm (0.700") | CP2623-91PRM088 |
| Ø19.1mm (0.750") 3/4" | CP2623-92PRM088 |
| Ø20.6mm (0.842") 13/16" | CP2623-93PRM088 |
| Ø22.2mm (0.875") 7/8" | CP2623-94PRM088 |
| Ø23.8mm (0.937") 15/16" | CP2623-95PRM088 |
| Ø25.4mm (1.000") | CP2623-96PRM088 |

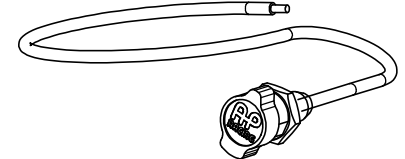

CP2805-18 CABLE ADJUSTER, THIS IS INCLUDED WITH THIS PEDAL BOX

THIS TABLE SHOWS THE RECOMMENDED PUSHROD LENGTHS FOR CYLINDERS IN THIS BOX.

IF YOUR ORDERING THE CP5500-525UNF, THEN MAKE SURE YOU ORDER YOUR CYLINDERS WITH THE 'PRT' EXTENSION AND NOT THE 'PRM', eg CP2623-91PRT088

CP2623 CYLINDERS HAVE IMPERIAL THREADS ON THE INLET AND OUTLET. FOR METRIC THREADS ORDER CP5623 VERSIONS INSTEAD.

CYLINDERS WITH LONGER PUSHRODS CAN BE CUT DOWN.

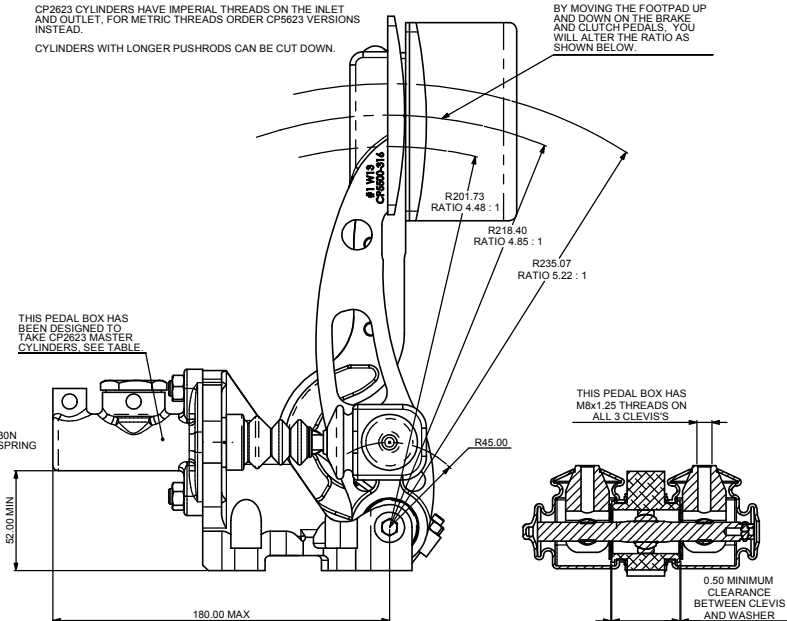
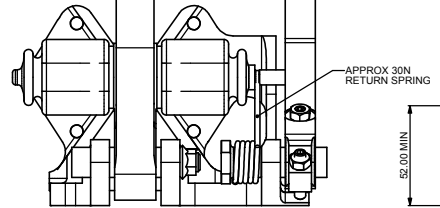
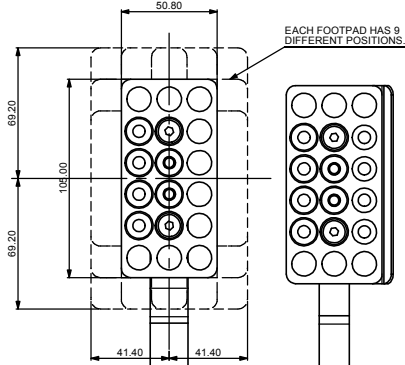
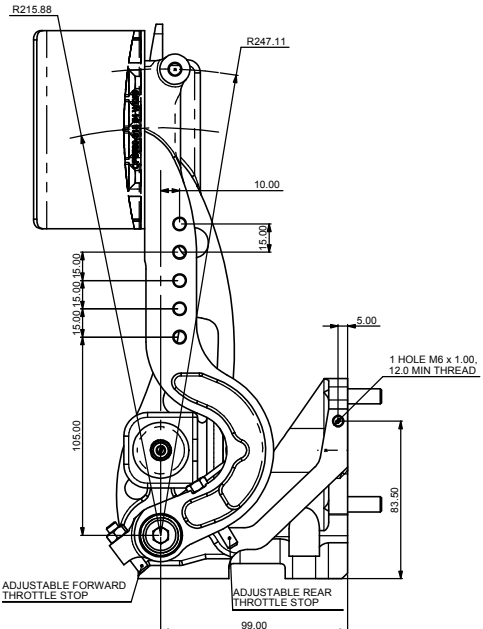

SCALE 1:1 SHEET 1 OF 2
 DRAWN Chris Arrowsmith
 APPROVED
 DERIVED FROM
 TITLE GENERIC FLOOR MTG PEDAL BOX
 DRG NO. CP5500-525CD

A0 INSTALLATION DRAWING

IF THIS DOCUMENT IS PRINTED IN HARD COPY, IT IS FOR INFORMATION USE ONLY AND THEREFORE IS NOT SUBJECT TO UPDATING CONTROLS. ALWAYS REFER TO SOLIDWORKS VIEWER FOR LATEST ISSUE



THIS DRAWING IS CONFIDENTIAL AND IS SUPPLIED ON THE EXPRESS CONDITION THAT IT SHALL NOT BE LOANED OR COPIED OR DISCLOSED TO ANY OTHER PERSON OR USED FOR ANY OTHER PURPOSE WITHOUT THE WRITTEN CONSENT OF AP RACING LTD.

AP RACING
 AP Racing
 Wheler Road
 Coventry
 CV3 4LB
 Tel: +44 024 7663 9585
 Fax: +44 024 7663 9559
 e-mail: sales@apracings.co.uk
 Web site: HTTP://www.apracings.com

OPTIONAL EXTRAS

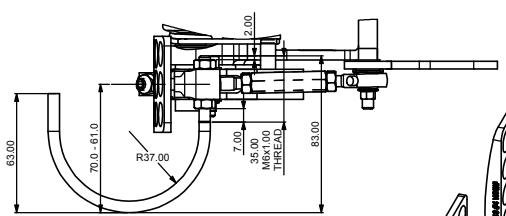

THROTTLE RELEASE KIT
 PART NUMBER: CP5500-44
 SOLD SEPARATELY

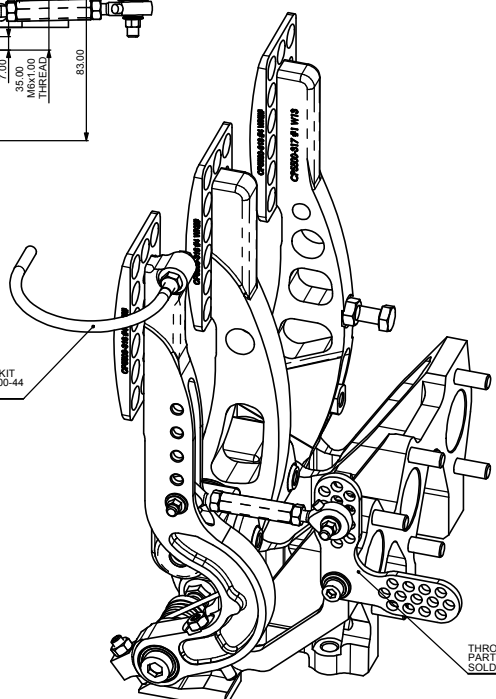

THROTTLE LINKAGE KIT
 PART NUMBER: CP5500-43
 SOLD SEPARATELY

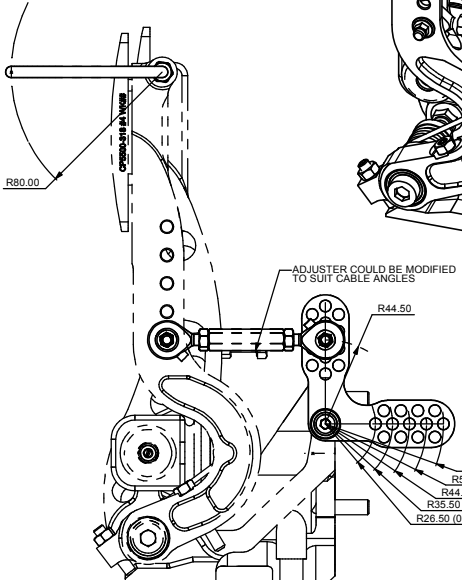

ADJUSTER COULD BE MODIFIED TO SUIT CABLE ANGLES

LARGER FOOTPAD
 PART NUMBER: CP5500-330
 SOLD SEPARATELY

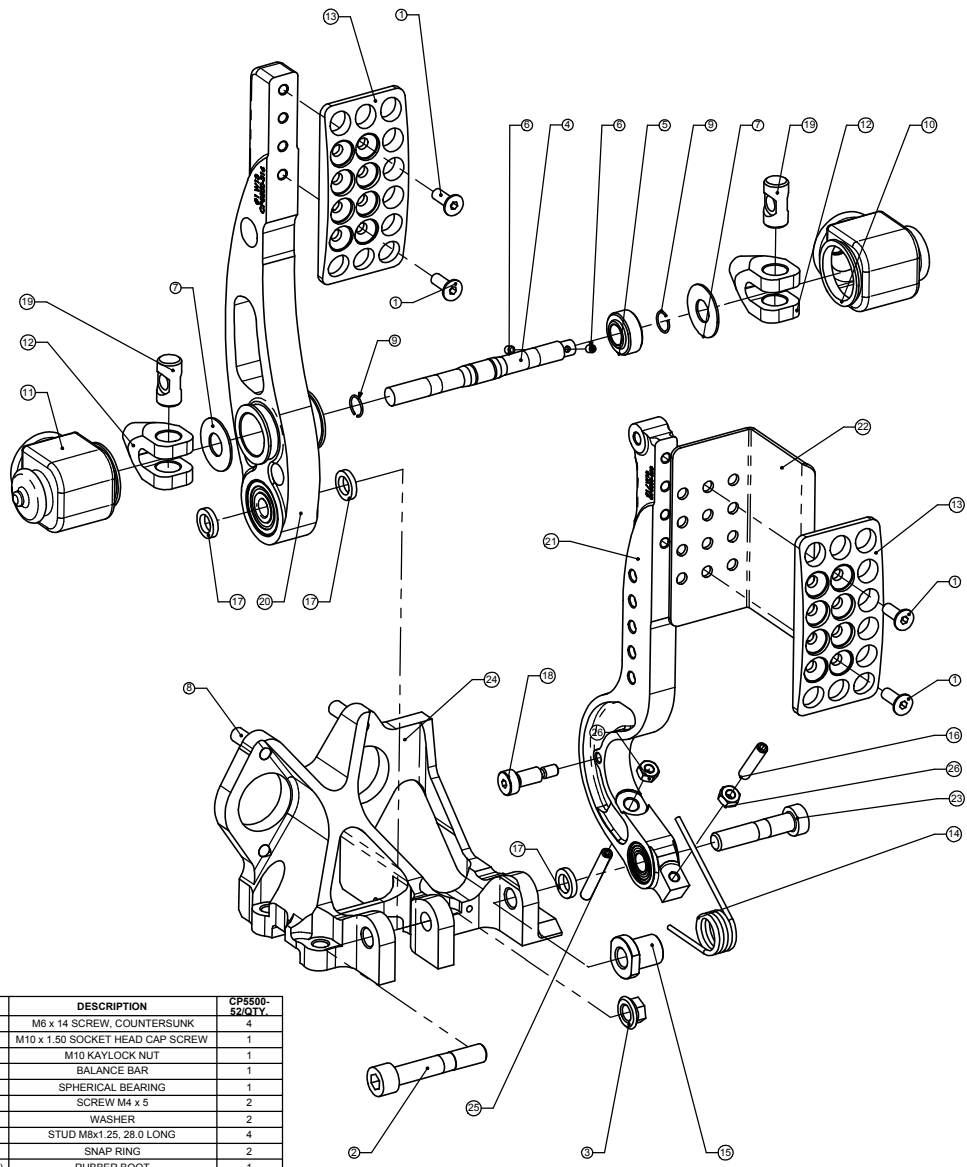
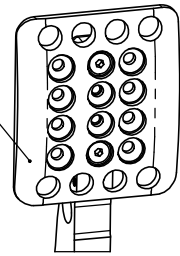

SPARES LIST

| ITEM NO. | PART NUMBER | DESCRIPTION | CP5500-52/QTY. |
|----------|-----------------------|----------------------------------|----------------|
| 1 | CP4350-106 | M6 x 14 SCREW, COUNTERSUNK | 4 |
| 2 | CP5200-173 | M10 x 1.50 SOCKET HEAD CAP SCREW | 1 |
| 3 | CP5427-101 | M10 KAYLOCK NUT | 1 |
| 4 | cp5500-105 | BALANCE BAR | 1 |
| 5 | CP5500-106 | SPHERICAL BEARING | 1 |
| 6 | cp5500-113st | SCREW M4 x 5 | 2 |
| 7 | CP5500-124 | WASHER | 2 |
| 8 | cp5500-133 | STUD M8x1.25, 28.0 LONG | 4 |
| 9 | CP5500-148 | SNAP RING | 2 |
| 10 | CP5500-150 (MODIFIED) | RUBBER BOOT | 1 |
| 11 | CP5500-150 | RUBBER BOOT | 1 |
| 12 | cp5500-312 | CLEVIS - METRIC | 2 |
| 13 | CP5500-318 | FOOTPAD | 2 |
| 14 | CP5500-321 | TORSION SPRING | 1 |
| 15 | CP5500-322 | SPRING SUPPORT BUSH | 1 |
| 16 | CP5500-324 | M6 SCREW x 30, FLAT GRUB | 1 |
| 17 | cp5518-127 | SPACER | 3 |
| 18 | CP7033-111 | M6 SCREW, Ø8 SHOULDER | 1 |
| 19 | cp5500-108 | BARREL NUT | 2 |
| 20 | CP5500-40 | BRAKE PEDAL SUB-ASSY | 1 |
| 21 | CP5500-42 | THROTTLE PEDAL SUB-ASSY | 1 |
| 22 | CP5500-329 | THROTTLE GUARD | 1 |
| 23 | CP4296-116 | M10 x 1.50 SOCKET HEAD CAP SCREW | 1 |
| 24 | CP5500-344 | CP5500 SERIES BASE PLATES | 1 |
| 25 | CP5500-338 | M6 SCREW x 35, FLAT GRUB | 1 |
| 26 | ME21001 | M6 x 1.00 NUT | 2 |

FOR UNF VERSION
 ITEM 12 - CP5500-191 - CLEVIS - IMPERIAL

| Alterations | | Date & No. | Particulars | Zone | Initials |
|-------------|-------|------------|------------------------------------|------|----------|
| 0 | 01/02 | | SEE SHEET 1 FOR ISSUE INFORMATION. | | |

| | |
|---|------------------|
| SCALE 1:1 | SHEET 1 OF 2 |
| DRAWN | Chris Arrowsmith |
| APPROVED | |
| DERIVED FROM | |
| TITLE GENERIC FLOOR MTG PEDAL BOX | |
| DRG NO. | CP5500-525CD |