

A2 INSTALLATION DRAWING

If this document is printed in hardcopy, it is for information use only and therefore is not subject to updating controls. Always refer to viewer for latest issue.

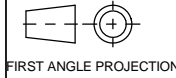

THIS DRAWING IS CONFIDENTIAL AND IS SUPPLIED ON THE EXPRESS CONDITION THAT IT SHALL NOT BE LOANED OR COPIED OR DISCLOSED TO ANY OTHER PERSON OR USED FOR ANY OTHER PURPOSE WITHOUT THE WRITTEN CONSENT OF AP RACING LTD.



AP Racing
Wheler Road
Coventry
CV3 4LB

Tel: +44 024 7663 9595
Fax: +44 024 7663 9559
e-mail: sales@apracing.co.uk
Web site: http://www.apracing.com

© AP Racing Ltd. 2005

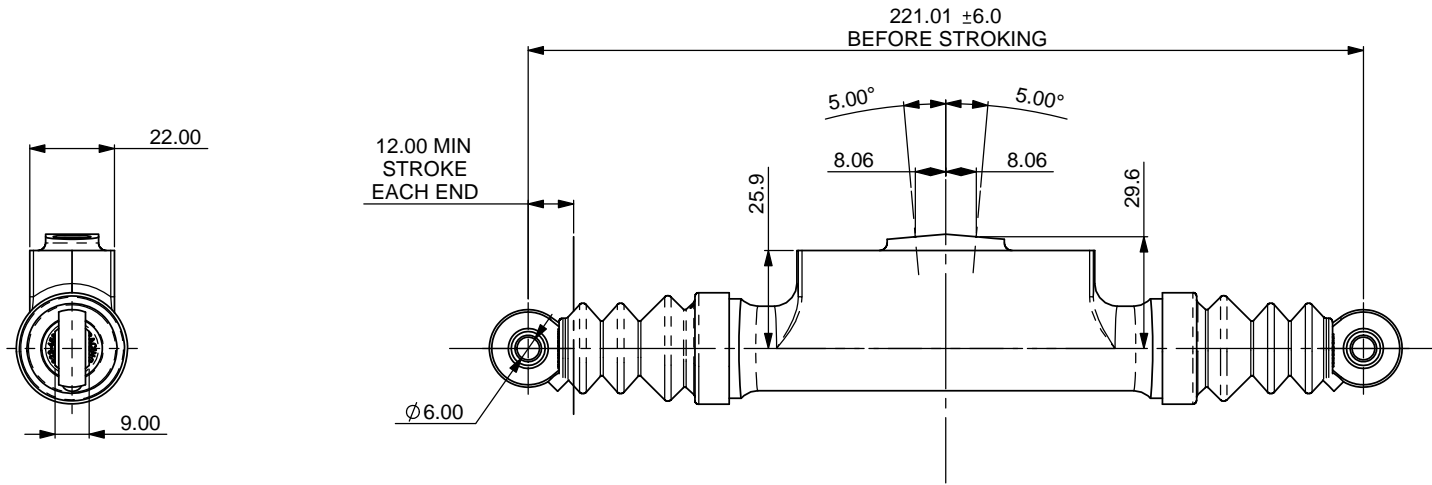

DATA:-

- WEIGHT..... 0.25Kg
- FULL STROKE..... 2 x 12mm
- BORE DIA..... 0.70" (17.8mm)
- TRAVEL TO CUT-OFF..... 1.09 TO 0.69mm (0.043" TO 0.027")
- HYDRAULIC THREADS..... M10 x 1.0 INLET
M10 x 1.0 OUTLET
- BODY MATERIAL..... ALUMINIUM ALLOY
- TYPICAL APPLICATIONS..... DUAL CIRCUIT HANDBRAKE SYSTEMS

GENERAL DESCRIPTION:-

LIGHT WEIGHT DOUBLE ENDED MASTER CYLINDER FOR USE IN DUAL CIRCUIT HANDBRAKE APPLICATIONS. PART IS SYMMETRICAL ABOUT ϕ

IMPORTANT NOTE:-

CP6026 MASTER CYLINDER IS INDIVIDUALLY SHIMMED DURING ASSEMBLY TO MINIMISE FREE PLAY. THEREFORE PUSH RODS AND ALL INTERNAL PARTS SHOULD NOT BE SWITCHED BETWEEN ENDS OR FROM OTHER MASTER CYLINDER ASSEMBLIES.

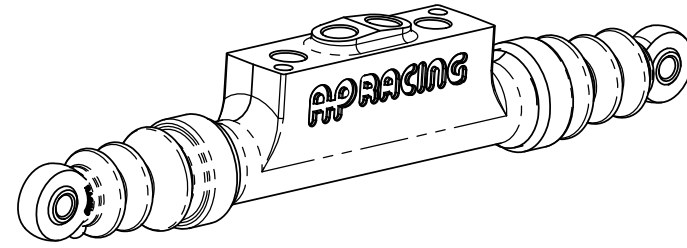
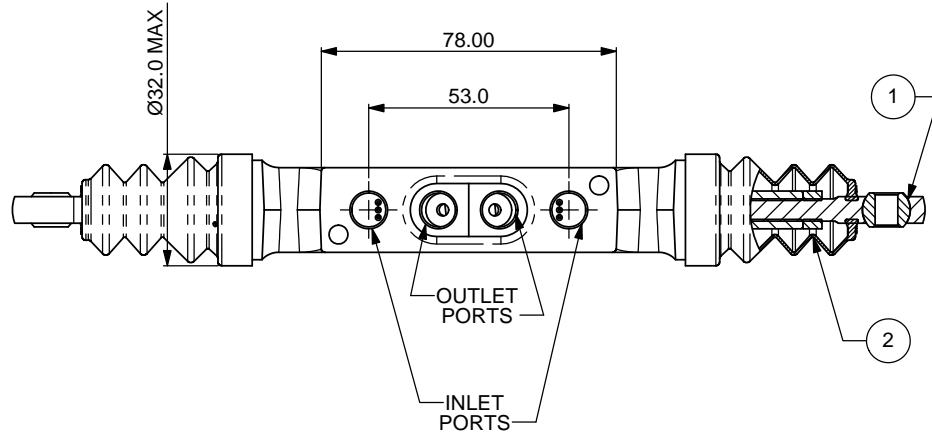

DOUBLE ENDED MASTER CYLINDER			
AP RACING PART No. CP6026-91			
SPARES LIST			
REF	DESCRIPTION	AP RACING PART No.	QTY/CYL
1	ROD END	CP6026-101	2
2	M6 NUT	ME21001	2
ADDITIONAL SPARE PARTS			
-	SEAL REPAIR KIT (2 OFF EACH PART) BOOTS, SEALS, PISTON WASHERS & CIRCLIPS	CP6025-91RK	-

Issue No.	Alterations		Zone	Initials
	Date & No.	Particulars		
1	28/09/06 B4639	FIRST ISSUE		SAT
2	19/06/13	TRAVEL TO CUT-OFF 1.09-0.69 WAS EXTRA SHORT 0.64-0.48	3D	SAT

SCALE 1:1	SHEET 1 OF 1
DRAWN	Steve Thomas
APPROVED	
DERIVED FROM	CP6025-91
TITLE	
DOUBLE ENDED MASTER CYLINDER	
DRG NO.	CP6026-91CD