

# A1 INSTALLATION DRAWING

IF THIS DOCUMENT IS PRINTED IN HARDCOPY, IT IS FOR INFORMATION USE ONLY AND THEREFORE IS NOT SUBJECT TO UPDATING CONTROLS. ALWAYS REFER TO SOLIDWORKS VIEWER FOR LATEST ISSUE



THIS DRAWING IS CONFIDENTIAL AND IS SUPPLIED ON THE EXPRESS CONDITION THAT IT SHALL NOT BE LOANED OR COPIED OR DISCLOSED TO ANY OTHER PERSON OR USED FOR ANY OTHER PURPOSE WITHOUT THE WRITTEN CONSENT OF AP RACING LTD.



AP Racing  
Wheler Road  
Coventry  
CV3 4LB

Tel: +44 (0) 24 7663 9595  
Fax: +44 (0) 24 7663 9559  
e-mail: engineering@apracings.co.uk  
Web site: http://www.apracings.com

© AP Racing Ltd. 2005

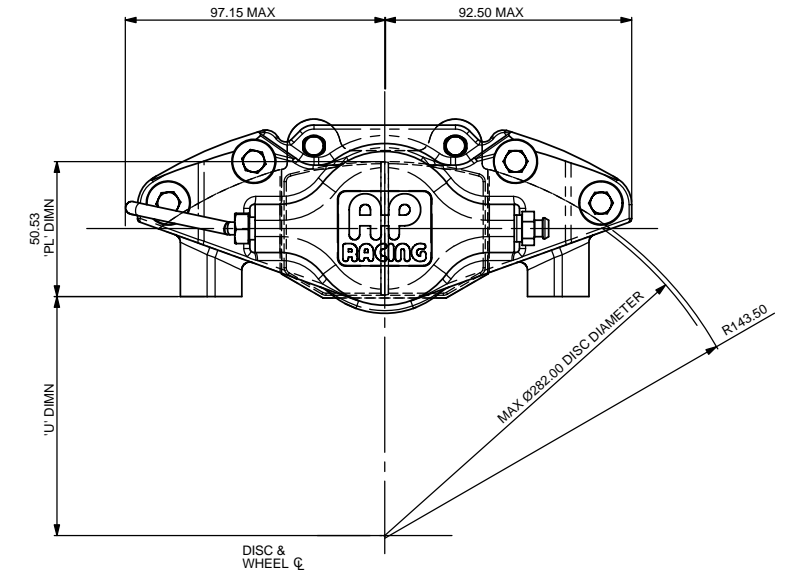
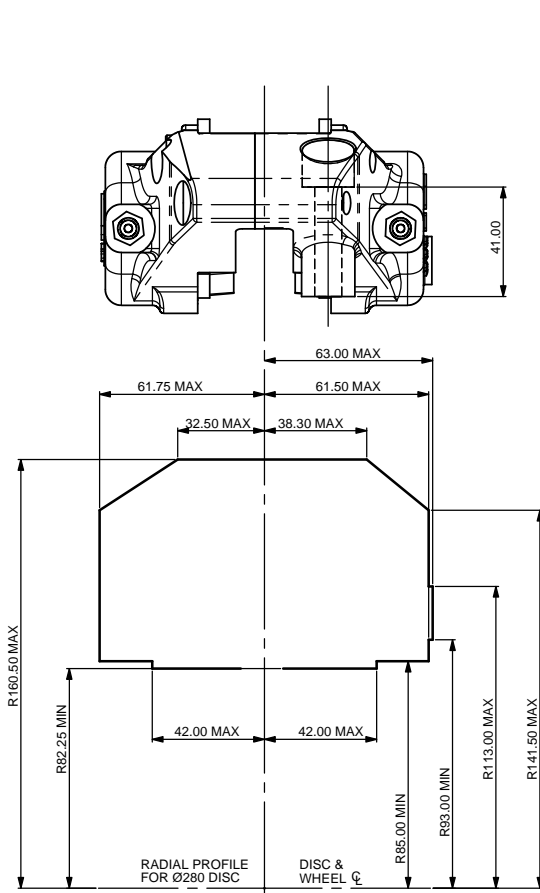

### General Description

This is a 2-pot caliper designed to operate on a iron disc up to Ø282mm x 17.8mm thick. All calipers are fitted with stainless steel bridge pipes as standard. High temperature / Low drag seals are fitted, and is of 'Seal In Bore' Type.

### Typical Application

Lightweight sports cars

### Technical & Installation Information

Piston Dia - 2 x 44.45  
Total Piston Area - 31.04cm<sup>2</sup>  
Piston Material - Aluminium Alloy  
Body Material - Aluminium Alloy  
All Hydraulic Threads M10 x 1.0

### Key To Dimensions

Dimension 'PL' Top of pad material to mounting boss face  
With pad sitting down on ledge.  
Dimension 'C' Disc centre line to mounting stud centre line.  
Dimension 'U' Wheel centre to caliper mounting boss face (disc diameter/2 - 'PL' Dimension).  
Dimension 'H' Mounting hole diameter.  
Radius 'N' Radius of disc pathway.  
Effective rad. Distance from wheel centre line to nominal piston centre line.

**AP Racing technical section will be pleased to advise on the most suitable equipment for any application.**

Should the piston be inadvertently removed, they should be wiped clean and be smeared with AP Racing brake fluid before replacement.

CP6126-2S4 - RIGHT HAND  
CP6126-3S4 - LEFT HAND

DISC & CALIPER MOUNTING TOLERANCES TO BE SUCH THAT DISC IS CENTRAL TO CALIPER TO WITHIN ±0.5.

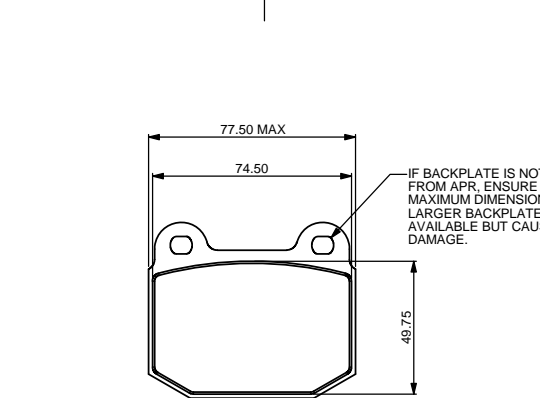

IF BACKPLATE IS NOT SUPPLIED FROM APR, ENSURE THE 77.50 MAXIMUM DIMENSION IS OBSERVED. LARGER BACKPLATES ARE AVAILABLE BUT CAUSE CALIPER DAMAGE.

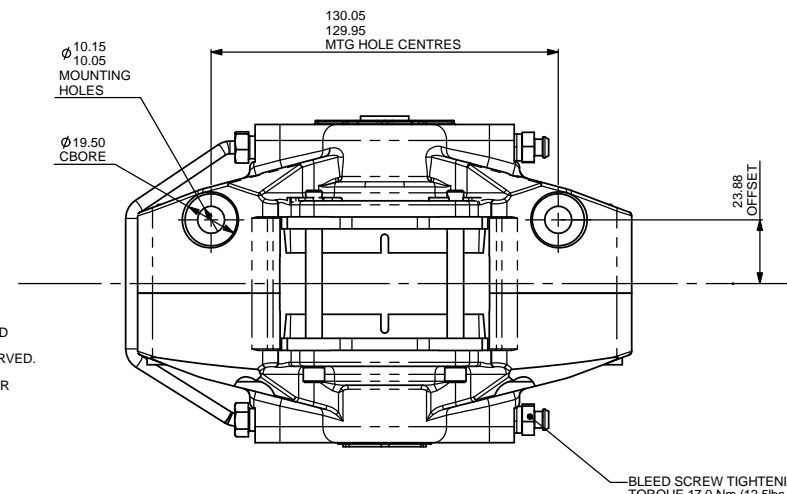

Issue No.	Alterations			Zone	Initials
	Date & No.	Particulars	#		
1	02/11/2009 B5716	FIRST ISSUE	#	CDA	
2	28/10/2013 RAC22111	MAX DISC 282 WAS 280.	#	CDA	

SCALE 1:1	SHEET 1 OF 1
DRAWN	Chris Arrowsmith
APPROVED	
DERIVED FROM	
TITLE	
2 x 1.75" RADIAL MOUNTING CALIPER ASSEMBLY	
DRG NO.	CP6126-1CD

CP5119 PAD FAMILY  
PAD AREA - 32.80cm<sup>2</sup>  
PAD VOLUME - 29.78cm<sup>3</sup>