

A0 INSTALLATION DRAWING

IF THIS DOCUMENT IS PRINTED IN HARD COPY, IT IS FOR INFORMATION USE ONLY AND THEREFORE IS NOT SUBJECT TO UPDATING CONTROLS. ALWAYS REFER TO SOLIDWORKS VIEWER FOR LATEST ISSUE

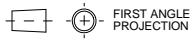

THIS DRAWING IS CONFIDENTIAL AND IS SUPPLIED ON THE EXPRESS CONDITION THAT IT SHALL NOT BE LOANED OR COPIED OR DISCLOSED TO ANY OTHER PERSON OR USED FOR ANY OTHER PURPOSE WITHOUT THE WRITTEN CONSENT OF AP RACING LTD.



AP Racing
 Wheeler Road
 Coventry
 CV3 4LB
 Tel: +44 (0)24 7663 9595
 Fax: +44 (0)24 7663 9599
 e-mail: sales@apracings.co.uk
 Web site: HTTP://www.apracings.com

Alterations		#	Date	Particulars	Zone	Issue
1	25/10/16 R4292	#		FIRST ISSUE		AT
2	06/01/17 R4292	#		RADIAL PROFILES REFINED (SHEET 2)		AT
3	18/05/17 R4292	4M		RETAINER TORQUE UPDATED: WAS 27.1Nm, NOW 19Nm		AT
4	17/07/17 R4292	1J		PART NUMBERING CONVENTION TABLE UPDATED WITH CORRECT PART NO.		AT
5	28/08/18 R4292_17	3P		DRY WEIGHT: 3.31KG ADDED TO CALIPER SPECIFICATION TABLE		SPB

CALIPER SPECIFICATION

BORE SIZE	DE (28.60 x 31.80) (1.125" x 1.25")
PISTON AREA	14.40cm²
DISC DIAMETER MAX	380.00
DISC THICKNESS MAX	32.00
DISC THICKNESS MIN (WORN CONDITION)	30.00 (DIFFERENTIAL WEAR NOT TO EXCEED 0.50mm SIDE TO SIDE)
WORKING PRESSURES	SEE DATA SHEET P14.354 (AVAILABLE FROM AP RACING TECHNICAL DEPT)
HYDRAULIC FEED	M10 x 1.0
DRY WEIGHT (LESS PADS)	3.31kg
PAD FAMILY	CP6600
EFFECTIVE RADIUS (ON DIAMETER 380.00 DISC)	162.50
PL' DIMENSION	55.00
OFFSET 'C' DIMENSION	36.00
MOUNTING HOLE CENTRES 'D' DIMENSION	195.00
PAD FRICTION MATERIAL MIN THICKNESS	2.50
PAD RETENTION	2 x FRICTION RETAINED PINS
TIGHTENING TORQUES	BLEED SCREW: 17Nm HYDRAULIC FEED: 25Nm RETAINER BOLTS: 19Nm
CORROSION PROTECTION	FLUID RESISTANT PAINT FINISH ALUMINIUM BODY BOOT TYPE DIRT SEALS

CALIPER POSITIONING

RHT	RIGHT HAND TRAILING (BEHIND AXLE)
LHT	LEFT HAND TRAILING (BEHIND AXLE)
RHL	RIGHT HAND LEADING (IN FRONT OF AXLE)
LHL	LEFT HAND LEADING (IN FRONT OF AXLE)

PART NUMBERING CONVENTION

PART NUMBER	DESCRIPTION
CP9541-2S0	RHT - SIDE FEED - NO ANTI KNOCK BACK SPRINGS
CP9541-3S0	LHT - SIDE FEED - NO ANTI KNOCK BACK SPRINGS
CP9541-4S0	RHL - SIDE FEED - NO ANTI KNOCK BACK SPRINGS
CP9541-5S0	LHL - SIDE FEED - NO ANTI KNOCK BACK SPRINGS

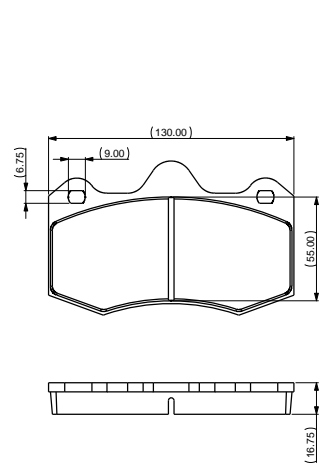

CP6600 PAD FAMILY
 PAD AREA (MAX) 64.6cm²

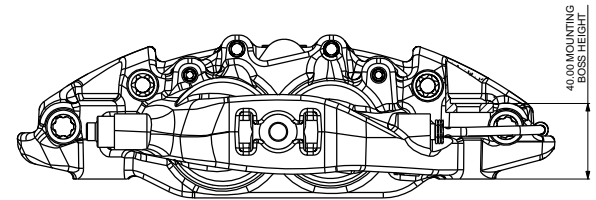
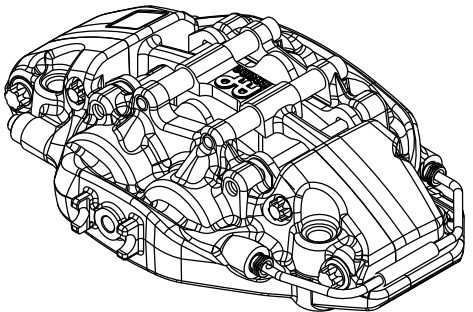
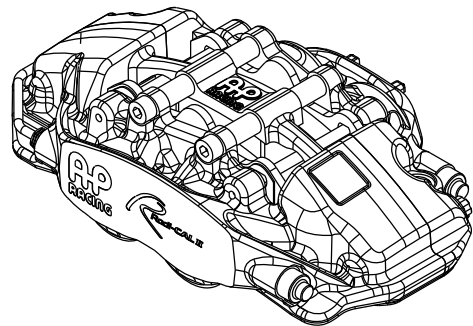
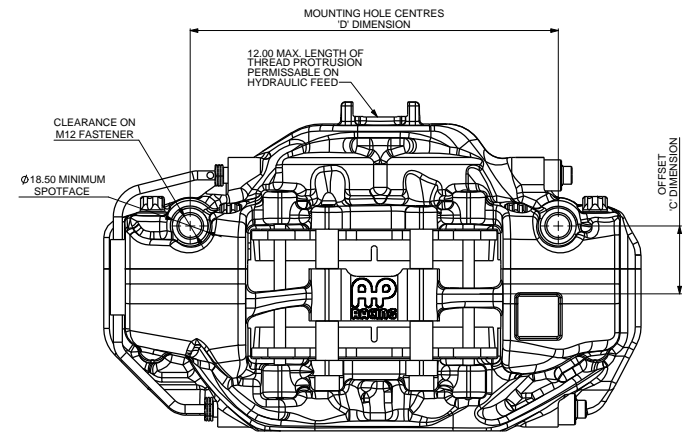
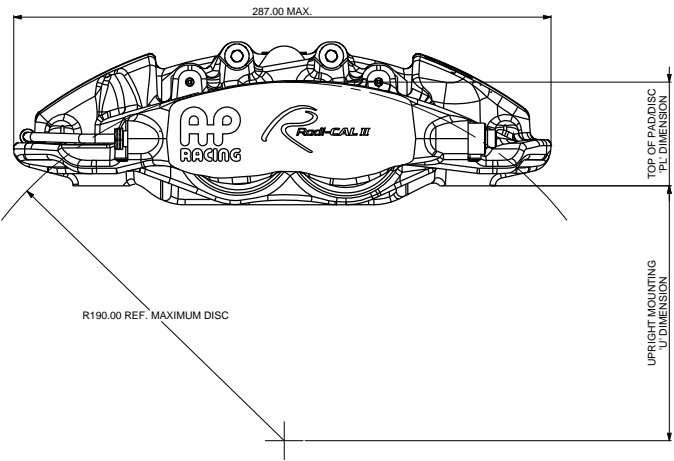

FOR INSTALLED PROFILES SEE SHEET 2

SCALE 1:1	SHEET 1 OF 2
DRAWN ALTHORPE	
APPROVED	
DERIVED FROM	
TITLE CALIPER INSTALLATION DRAWING Ø380 x 32 MAX DISC (DE BORES)	
DRG NO.	cp9541-1cd

A0 INSTALLATION DRAWING

IF THIS DOCUMENT IS PRINTED IN HARDCOPY, IT IS FOR INFORMATION USE ONLY AND THEREFORE IS NOT SUBJECT TO UPDATING CONTROLS. ALWAYS REFER TO SOLIDWORKS VIEWER FOR LATEST ISSUE

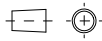

FIRST ANGLE PROJECTION

THIS DRAWING IS CONFIDENTIAL AND IS SUPPLIED ON THE EXPRESS CONDITION THAT IT SHALL NOT BE LOANED OR COPIED OR DISCLOSED TO ANY OTHER PERSON OR USED FOR ANY OTHER PURPOSE WITHOUT THE WRITTEN CONSENT OF AP RACING LTD.



AP Racing
 Wheeler Road
 Coventry
 CV3 4LB
 Tel: +44 (0)24 7663 9595
 Fax: +44 (0)24 7663 9559
 e-mail: sales@apracings.co.uk
 © AP Racing Ltd. 2016
 Web site: HTTP://www.apracings.com

Alterations		Zone	Index
Date & No.	Particulars		
-	SEE SHEET 1 FOR ISSUE INFORMATION.	-	-

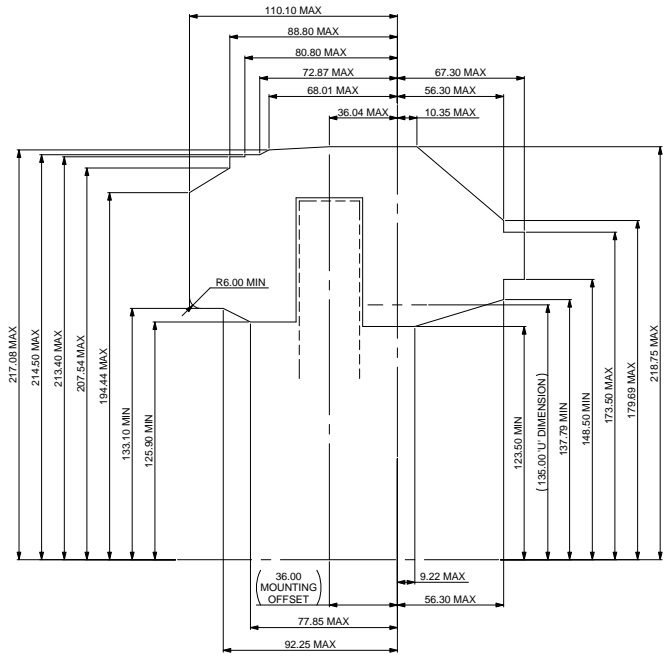

**CALIPER INSTALLED PROFILE
 ON Ø380.0 x 32.00 DISC**

SCALE 1:1	SHEET 2 OF 2
DRAWN A.THORPE	
APPROVED	
DERIVED FROM	
TITLE	
CALIPER INSTALLATION DRAWING	
Ø380 x 32 MAX DISC (DE BORES)	
DRG NO.	cp9541-1cd