

# PUBLICATION P12.283

ISSUE: 2

FOR DISC REPLACEMENT REQUIREMENTS,  
PLEASE ORDER KIT # **CP6895-01M.G8** \*

If this document is printed in hardcopy,  
it is for information use only and therefore is  
not subject to updating controls. Always  
refer to viewer for latest issue.

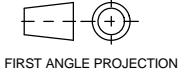

THIS DRAWING IS CONFIDENTIAL AND IS SUPPLIED ON THE EXPRESS CONDITION THAT  
IT SHALL NOT BE LOANED OR COPIED OR DISCLOSED TO ANY OTHER PERSON OR USED  
FOR ANY OTHER PURPOSE WITHOUT THE WRITTEN CONSENT OF AP RACING LTD.



AP Racing  
Wheler Road  
Coventry  
CV3 4LB

Tel: +44 024 7663 9595  
Fax: +44 024 7663 9559  
e-mail: sales@ap racing.co.uk  
Web site: HTTP://www.ap racing.com

© AP Racing Ltd. 2005

## BMW E92 M3 FRONT KIT NUMBER CP5555M1049

Ref	DESCRIPTION	QTY
1	BMW FRONT UPRIGHT	-
2	CALIPER RIGHT HAND CALIPER LEFT HAND	1 1
3	VENTED DISC RIGHT HAND VENTED DISC LEFT HAND	1 1
4	MOUNTING BELL	2
5	MOUNTING BRACKET	2
6	M12x42 BRACKET Mtg BOLT	4
7	BRACKET WASHER	4
8	0.5mm SHIM	12
9	M12x65 CALIPER Mtg BOLT	4
10	CALIPER WASHER	4
11	ANTI-RATTLE CLIP	2
12	HOSE	2
13	GASKET	4
14	BANJO BOLT	2
15	TOP HAT SLEEVE	24
16	STEEL STRAP	72
17	0.25UNF DISC MOUNTING BOLT	48
18	0.25UNF STRAP MOUNTING BOLT	48
19	PAD RETAINER INSERTS	4
20	Ø 12.5 DISC WASHER	24
21	0.25UNF NUT	48
22	PAD SET (4)	2
23	PAD RETRACTION GUIDE PIN	2
24	PAD RETRACTION SPRING	2
25	PAD RETAINER BOLTS	4

Tightening Torques	
Part Ref #	Torque
Bolt Ref 6	68NM
Bolt Ref 9	68NM
Bolt/Nut Ref 18/19	14NM
Caliper Bleed Screw	17NM
Banjo Bolt Ref 15	25NM
Pad Retainer Bolt 25	13NM

BRAKE DISC WEAR	
NEW	MIN WORN
36.00mm	34.00mm

### Comments

Check caliper is central over disc, use 0.5mm shims (Part Ref 8) to adjust  
bracket if required, note discs assembly direction arrow  
Illustration is of right hand assembly

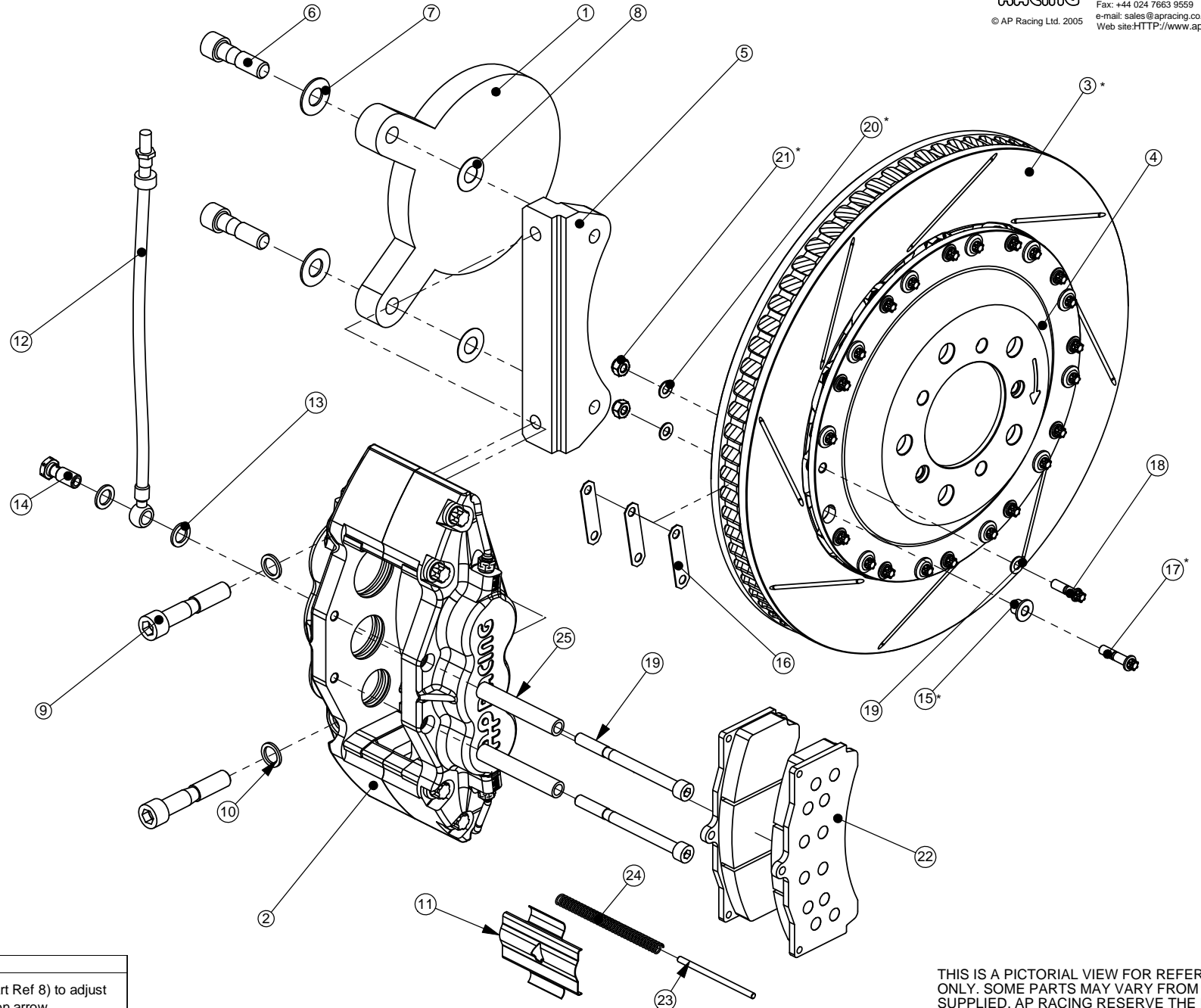

THIS IS A PICTORIAL VIEW FOR REFERENCE  
ONLY. SOME PARTS MAY VARY FROM THOSE  
SUPPLIED. AP RACING RESERVE THE RIGHT  
TO CHANGE COMPONENTS WITHOUT PRIOR  
NOTICE.

Drawn By: Carl Johns

**PLEASE RETAIN THIS SHEET FOR FUTURE REFERENCE**